

BOM Table					
ITEM NO.	PART NUMBER	Rev.	Description	Material	HN-57-01-PKA-L/QTY.
1	HN-68-11	1	ASSEMBLY		1
2	PK-084A	1	POLE MOUNT KIT		1
2.1	PK-08C-00	3	MOUNTING CHANNEL	304SS	2
2.2	W-002	0	FENDER WASHER .734 X .203 X .04	SST	4
2.3	CL-01	1	Hose Clamp, 2" to 12.25" ID, 30 in.-lbs. Max Torque	201 SST, ZINC SCREW	2
2.4	SCREWS-044	0	#8-16 X 1/2 PLASTITE, PAN HEAD, PHILLIPS, SST	SST	4

BOM Table					
ITEM NO.	PART NUMBER	Rev.	Description	Material	HN-57-01-PKA-W/QTY.
11	HN-68-11	1	ASSEMBLY		1
12	PK-068A	1	POLE MOUNT KIT		1
12.1	PK-06C-00	3	MOUNTING CHANNEL	304SS	2
12.2	W-002	0	FENDER WASHER .734 X .203 X .04	SST	4
12.3	CL-01	1	Hose Clamp, 2" to 12.25" ID, 30 in.-lbs. Max Torque	201 SST, ZINC SCREW	2
12.4	SCREWS-044	0	#8-16 X 1/2 PLASTITE, PAN HEAD, PHILLIPS, SST	SST	4

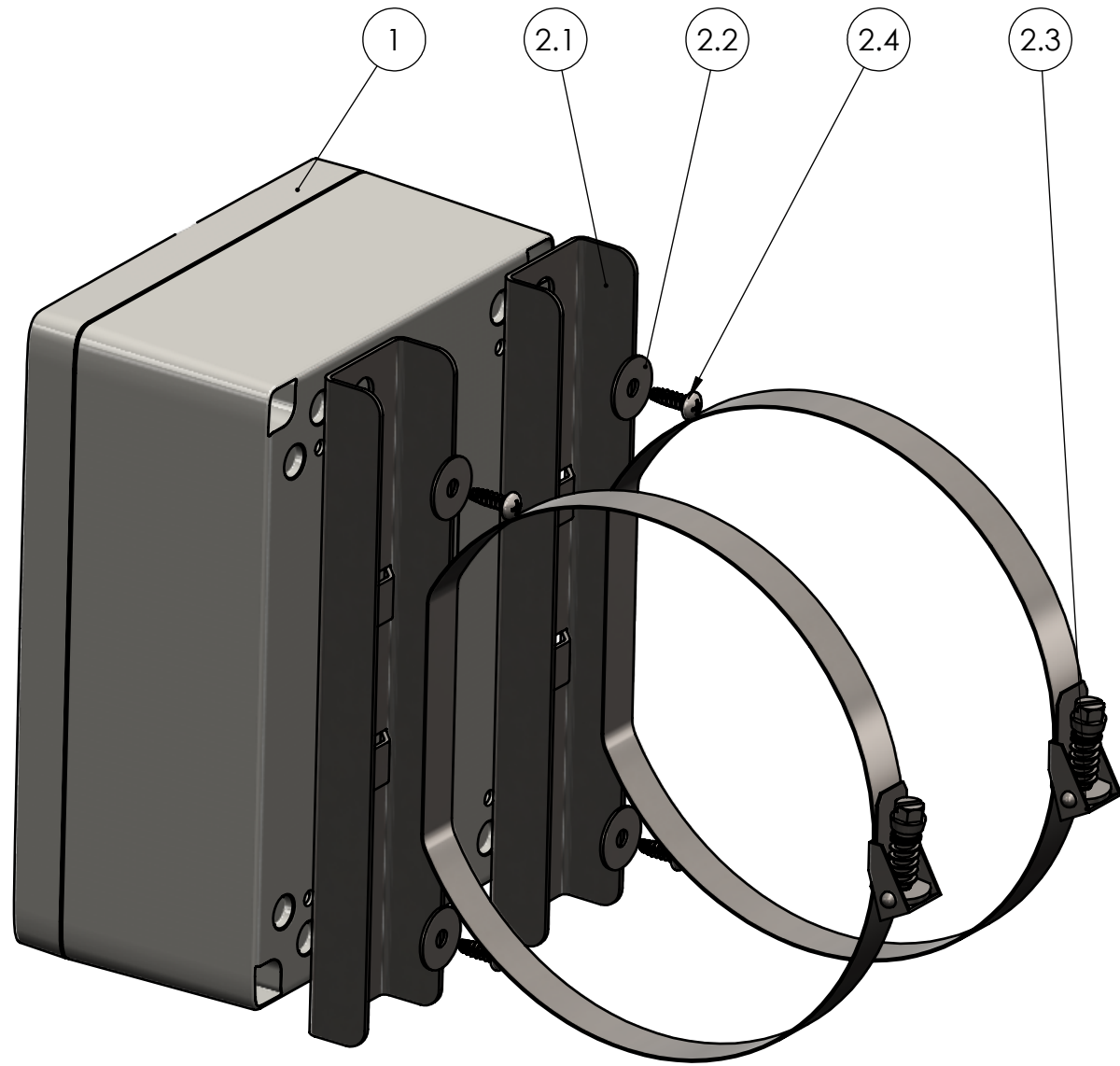

HN-68-11-PKA-L

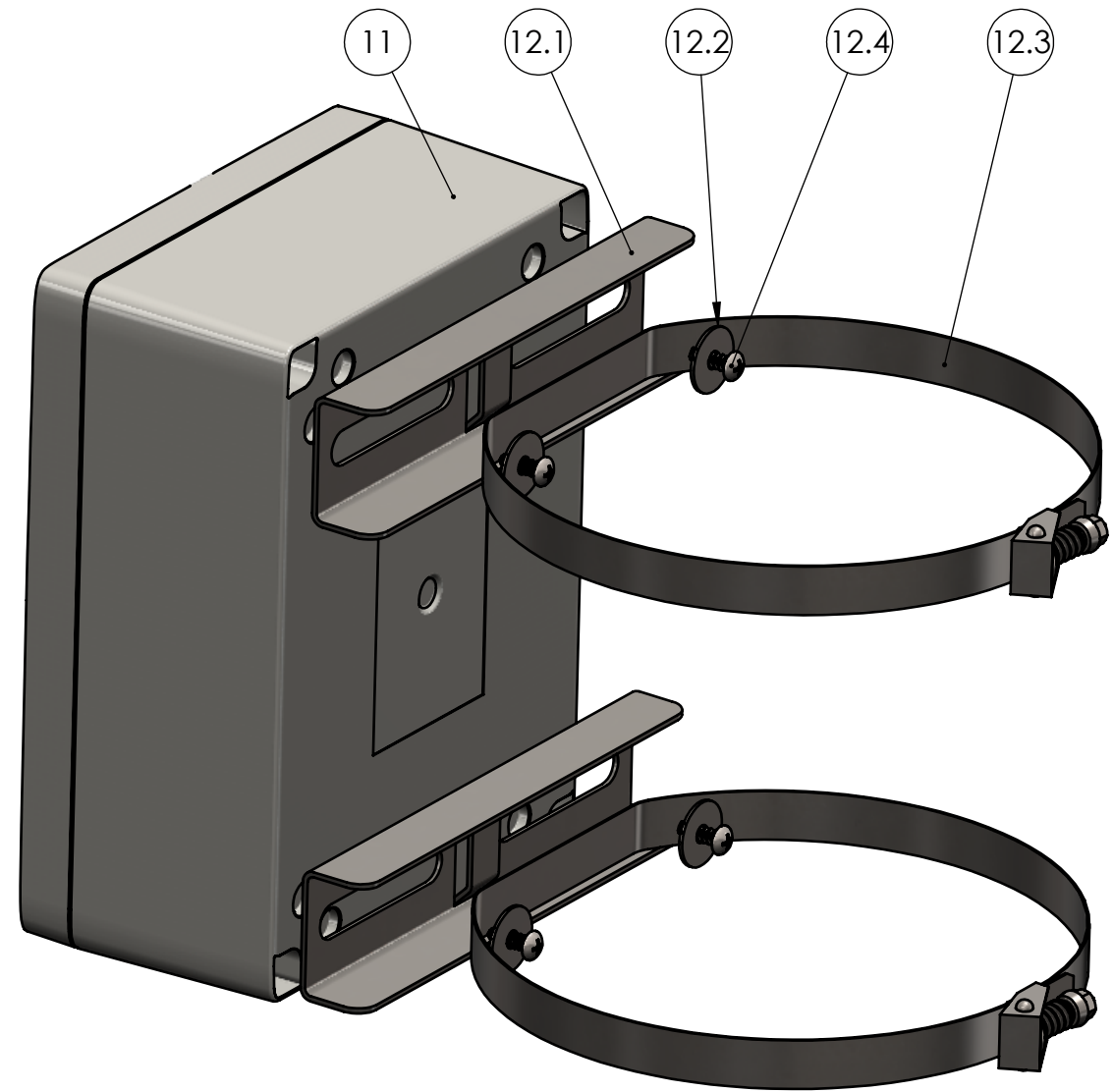

HN-68-11-PKA-W

REV.	COMMENT	ZONE	REVISED BY	CREATION DATE
0			Douglas French	2/26/2025
REVISIONS				

UNLESS OTHERWISE SPECIFIED:  
 DIMENSIONS ARE IN: INCHES [mm]  
 TOLERANCES: ANGULAR: ±2°  
 TWO PLACE DECIMAL: ±.010  
 THREE PLACE DECIMAL: ±.005  
 PRINTED GRAPHICS: ±.010

PROPRIETARY AND CONFIDENTIAL  
 THE INFORMATION CONTAINED IN THIS  
 DRAWING IS THE SOLE PROPERTY OF  
 POLYCASE. ANY REPRODUCTION IN PART  
 OR AS A WHOLE WITHOUT THE WRITTEN  
 PERMISSION OF POLYCASE IS PROHIBITED.  
 CAD FILE: HN-68-11-PKA

PART NO. HN-68-11-PKA-L	
MATERIAL	
FLAME RATING	SIZE <b>B</b>
DRAWN	NAME
CHECKED	DATE
-	2/26/2025

**polycase**  
1305 CHESTER IND. PARKWAY AVON, OHIO 44011-1083 U.S.A.  
 PH#: 1-800-248-1233, 440-934-0444 FAX#: 440-934-0088

REV  
**0**

SCALE: 1:2

SHEET 1 OF 2

8 7 6 5 4 3 2 1

D  
C  
B  
A

D  
C  
B  
A

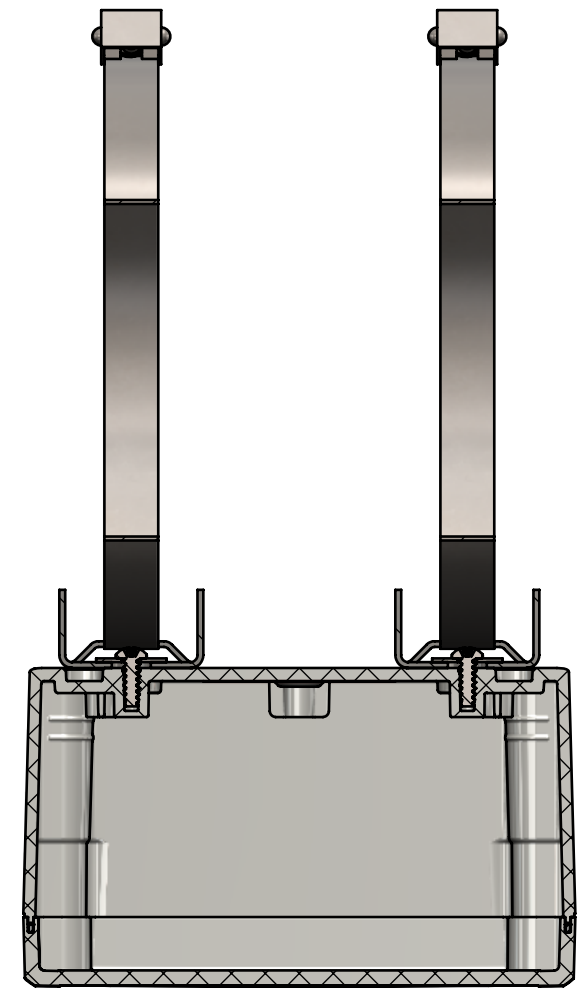
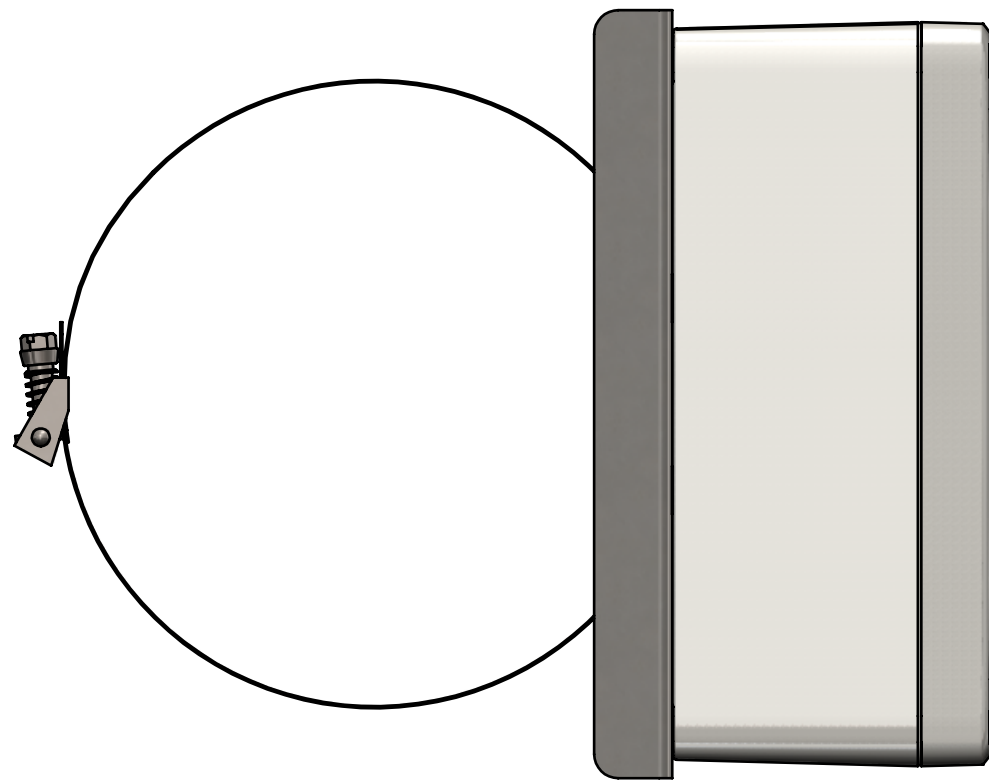
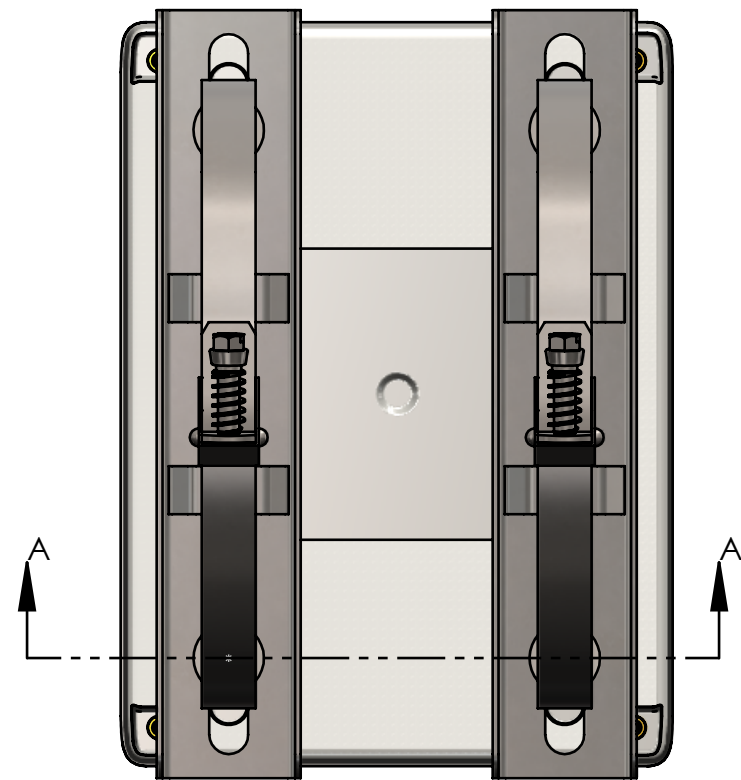

SECTION A-A

UNLESS OTHERWISE SPECIFIED:  
DIMENSIONS ARE IN: INCHES [mm]  
TOLERANCES: ANGULAR: ±2°  
TWO PLACE DECIMAL: ±.010  
THREE PLACE DECIMAL: ±.005  
PRINTED GRAPHICS: ±.010

PROPRIETARY AND CONFIDENTIAL  
THE INFORMATION CONTAINED IN THIS  
DRAWING IS THE SOLE PROPERTY OF  
POLYCASE. ANY REPRODUCTION IN PART  
OR AS A WHOLE WITHOUT THE WRITTEN  
PERMISSION OF POLYCASE IS PROHIBITED.  
CAD FILE: HN-68-11-PKA

PART NO.  
HN-68-11-PKA-L  
MATERIAL

FLAME RATING

DRAWN  
CHECKED

NAME  
D.M.F.

DATE  
2/26/2025

SIZE  
**B**

SCALE: 1:2



1305 CHESTER IND. PARKWAY AVON, OHIO 44011-1083 U.S.A.  
PH#: 1-800-248-1233, 440-934-0444 FAX#: 440-934-0088

REV  
**0**

SHEET 2 OF 2

8 7 6 5 4 3 2 1