

ITEM NO.	PART NUMBER	DESCRIPTION	QTY.
1	WH-xx	Hinged Nema Enclosure, Outdoor Use, with Flange Kit	1
2	PK-xxx	POLE MOUNT KIT	1
2.1	SC-120	Strut Channel P4100SLPG	2
2.2	SW-001	Strut Channel Washer 1/4	4
2.3	SCREWS-031	1/4-20 X .75 PAN HEAD, PHILLIPS, SS	4
2.4	W-002	FENDER WASHER #10 X .734 X .04	4
2.5	SN-001	Strut Channel NUT 1/4-20	4
2.6	CL-01	Hose Clamp, 2" to 12.25" ID, 30 in.-lbs. Max Torque	2
2.7	SCREWS-052	#8-16 X 3/8 PLASTITE, PAN HEAD, PHILLIPS, SST	4

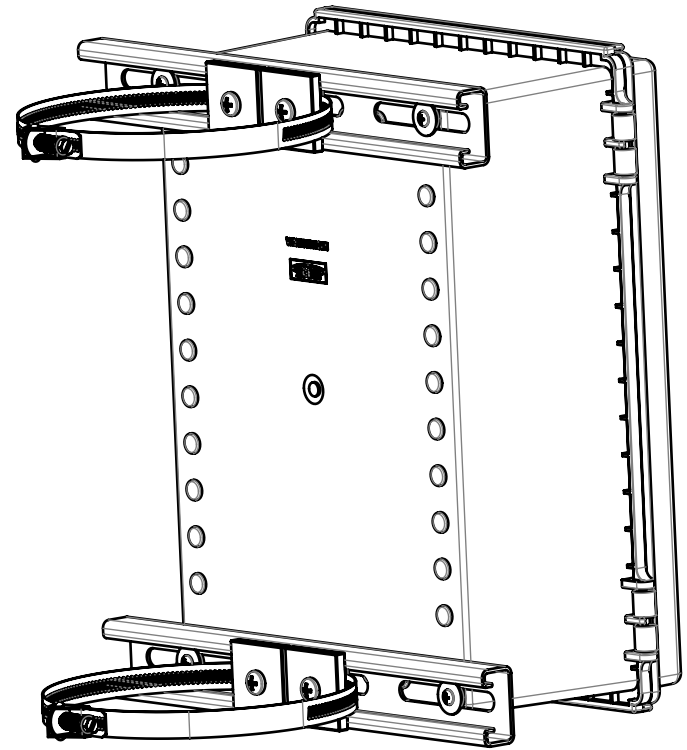
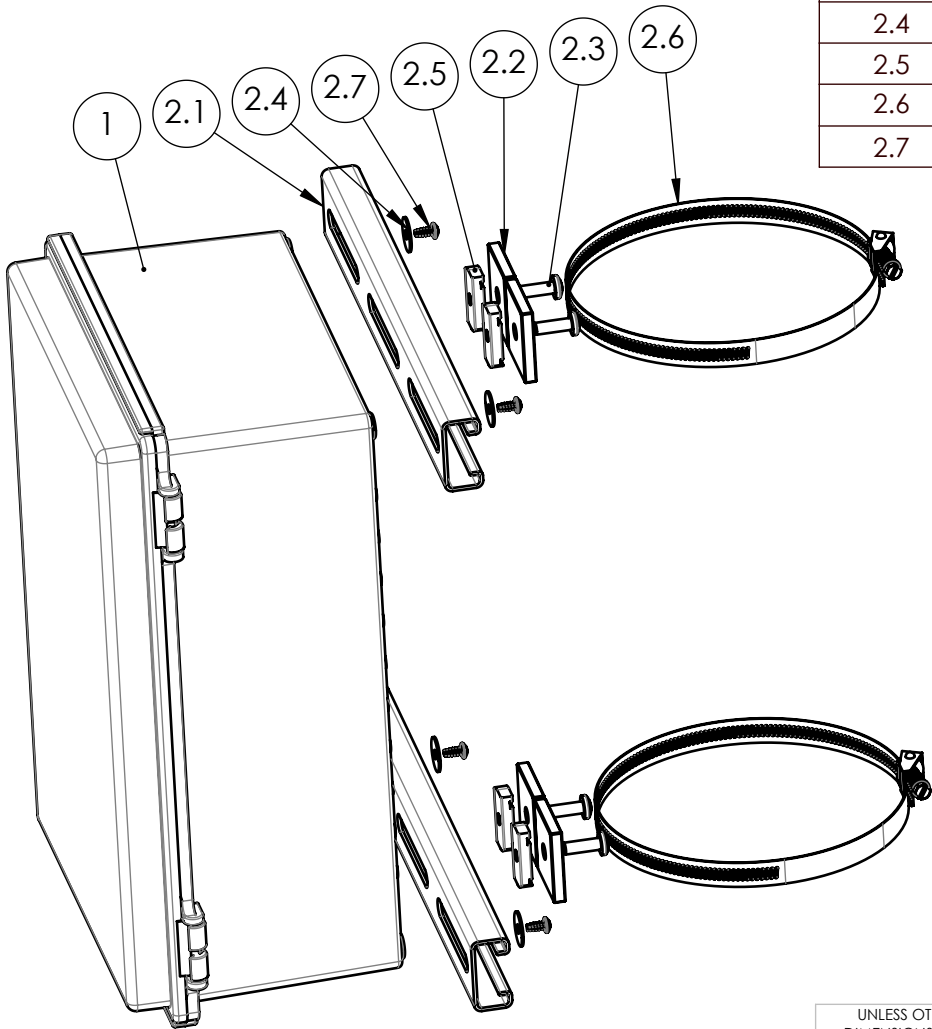

UNLESS OTHERWISE SPECIFIED:  
 DIMENSIONS ARE IN: INCHES[mm]  
 TOLERANCES: ANGULAR: ±2°  
 TWO PLACE DECIMAL: ±.010  
 THREE PLACE DECIMAL: ±.005  
 PRINTED GRAPHICS: ±.010

PROPRIETARY AND CONFIDENTIAL  
 THE INFORMATION CONTAINED IN THIS  
 DRAWING IS THE SOLE PROPERTY OF  
 POLYCASE. ANY REPRODUCTION IN PART  
 OR AS A WHOLE WITHOUT THE WRITTEN  
 PERMISSION OF POLYCASE IS PROHIBITED.  
 CAD FILE: PK-INST-09

PART NO.  
 PK-INST-09

MATERIAL

FLAME RATING

SIZE  
**A**

SCALE: 1:4

**polycase**  
 1305 CHESTER IND. PARKWAY AVON, OHIO 44011-1083 U.S.A.  
 PH#: 1-800-248-1233, 440-934-0444 FAX#: 440-934-0088

REV  
**0**

SHEET 1 OF 1

REV.	DESCRIPTION	ZONE	BY	APPR'D	DATE
5	REVISIONS				
4					
3					
2					
1					

5

4

3

2

1