

F
E
D
C
B
A

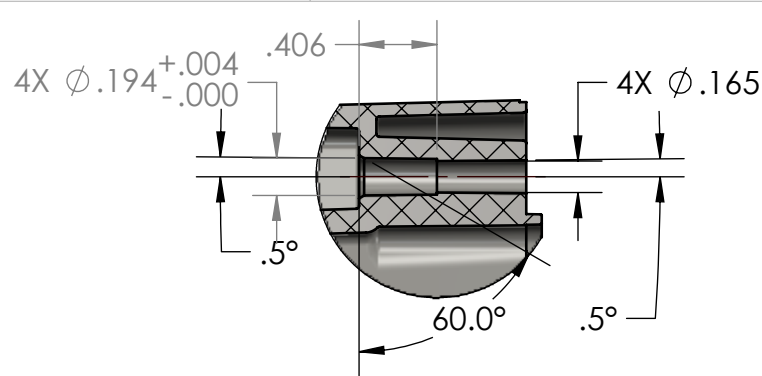

DETAIL D
SCALE 1 : 1
(6 PLCS.)

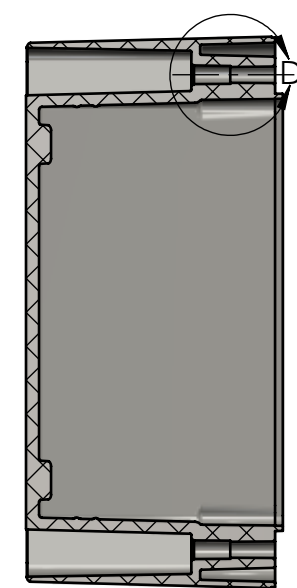

SECTION C-C

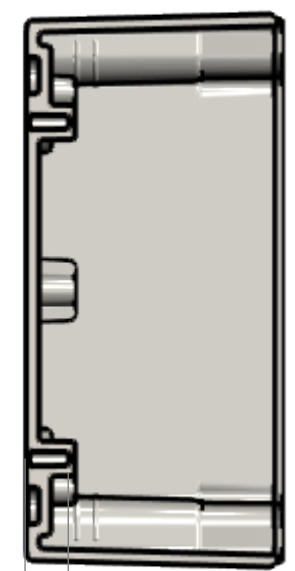
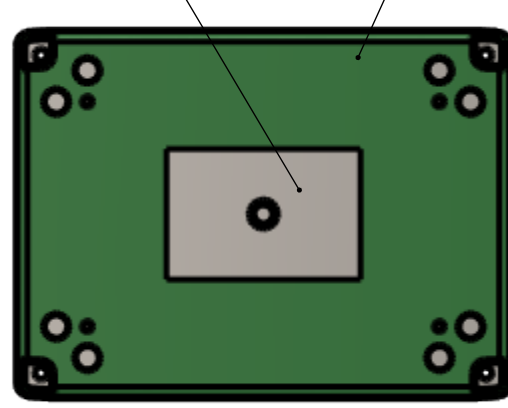
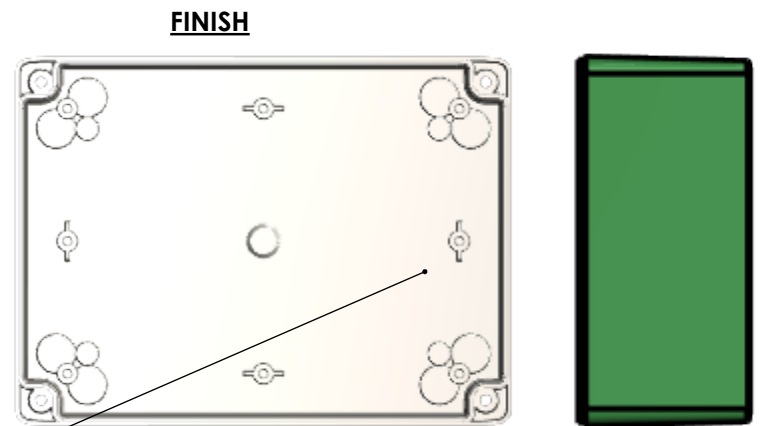

SECTION E-E

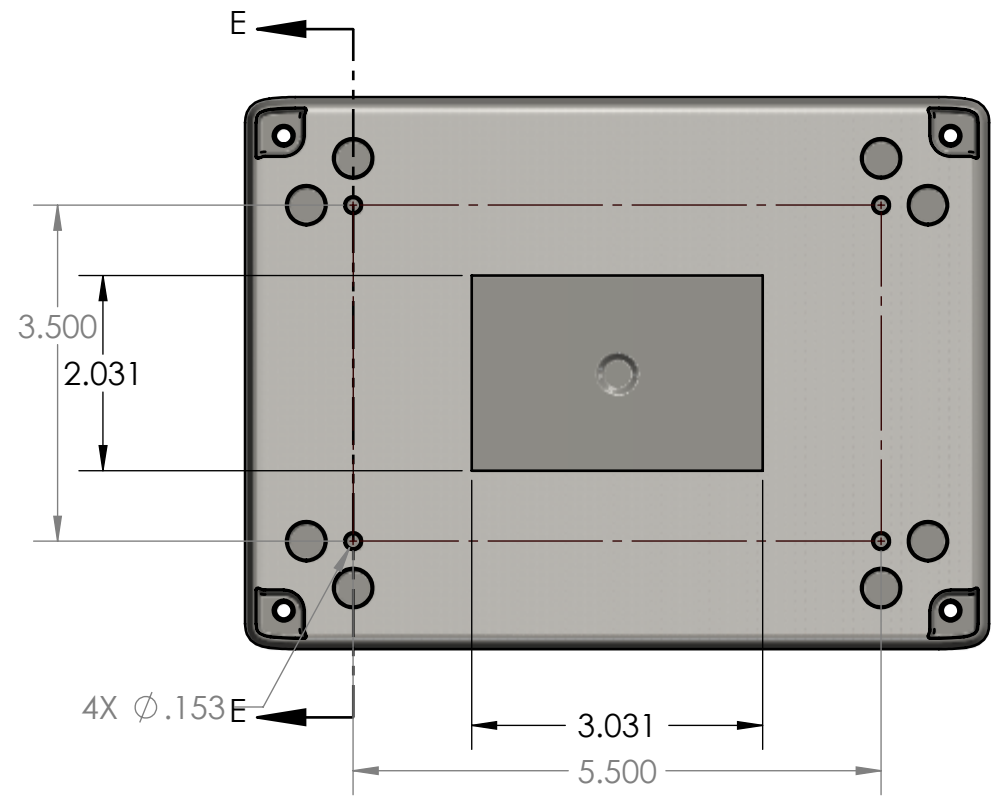
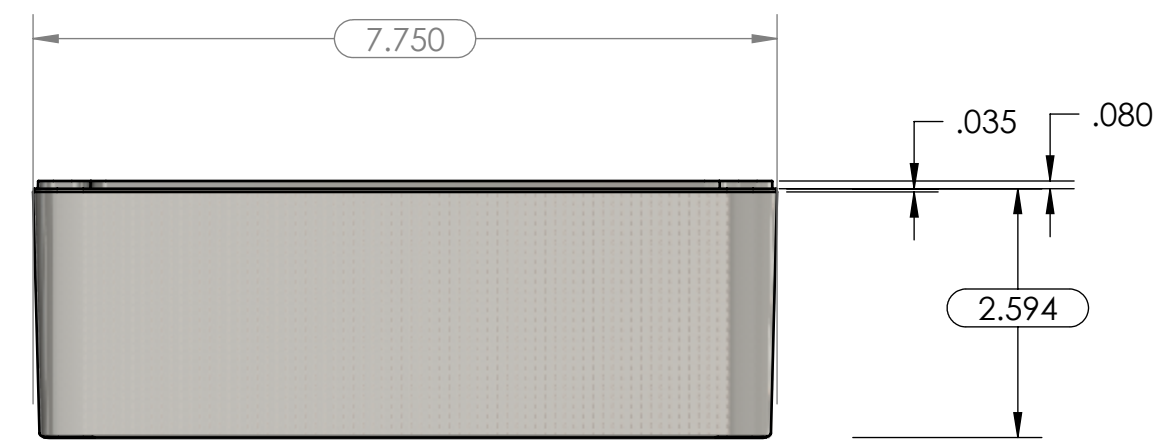
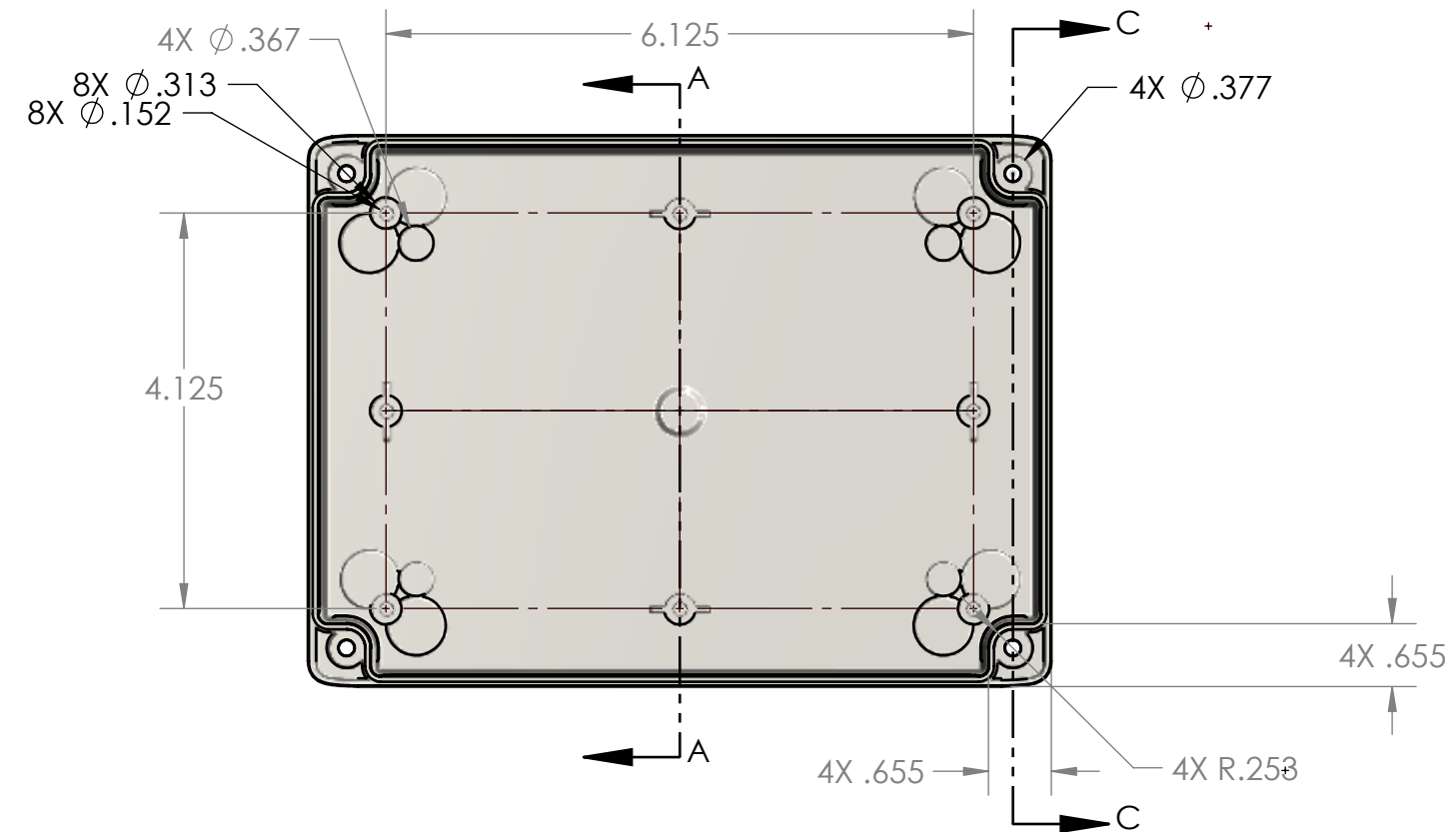

TOLERANCE CHART																
DIMENSION RANGE	0	.039	.118	.236	.394	.591	.866	1.181	1.575	2.087	2.756	3.543	4.724	6.299	7.874	9.843
TOOL DEPENDENT	±.007	±.007	±.008	±.008	±.009	±.010	±.011	±.012	±.013	±.015	±.017	±.020	±.024	±.028	±.035	.043
NON-TOOL DEPENDENT	±.003	±.004	±.004	±.004	±.005	±.006	±.007	±.008	±.009	±.011	±.013	±.016	±.020	±.024	±.031	.039

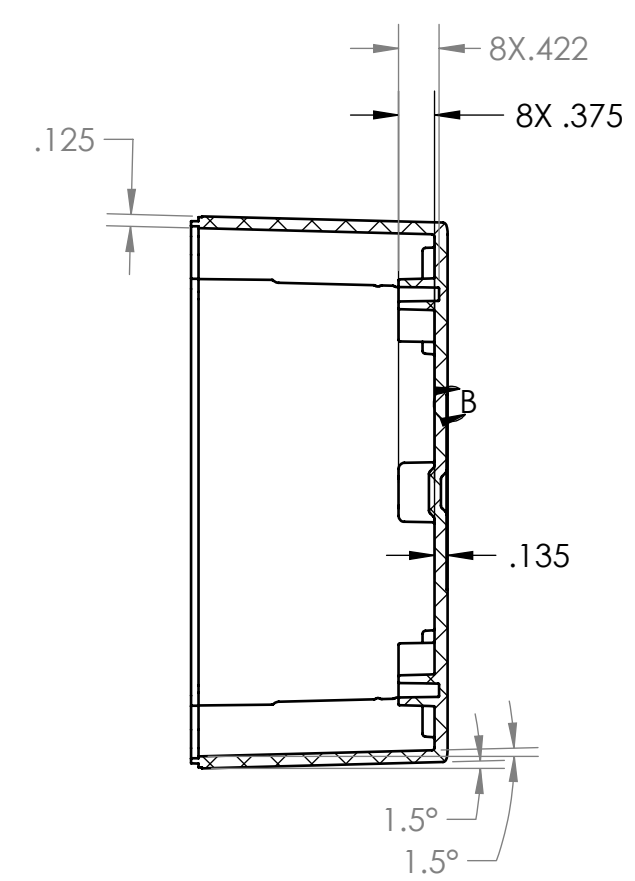
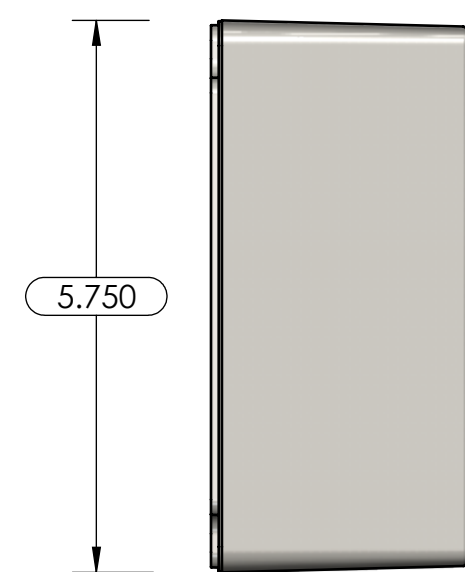

SECTION A-A

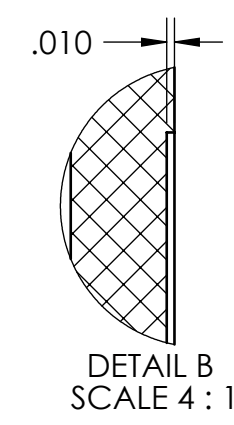

DETAIL B
SCALE 4 : 1

PART NUMBER: HN-68BPN-01
MATERIAL: PC
MATERIAL SPEC: /PC/XXX/GY
COLOR: LIGHT GRAY
FLAME RATING: UL94-5VA
WEIGHT(lbs): 0.6474

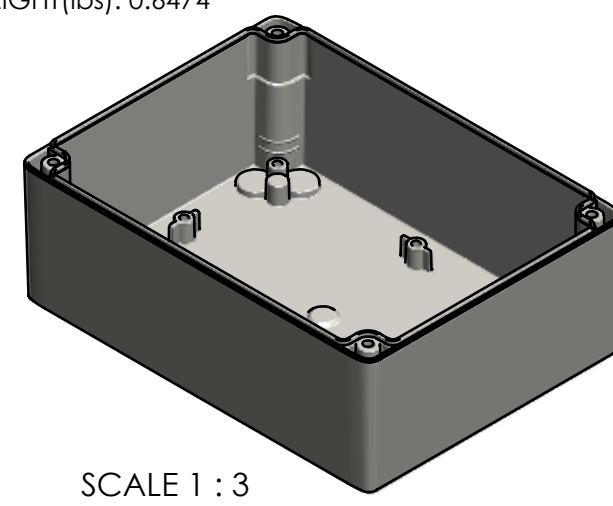

SCALE 1 : 3

PART NUMBER: HN-68BPN-00
MATERIAL: PC
MATERIAL SPEC: /PC/XXX/BK
COLOR: BLACK
FLAME RATING: UL94-5VA
WEIGHT(lbs): 0.6474

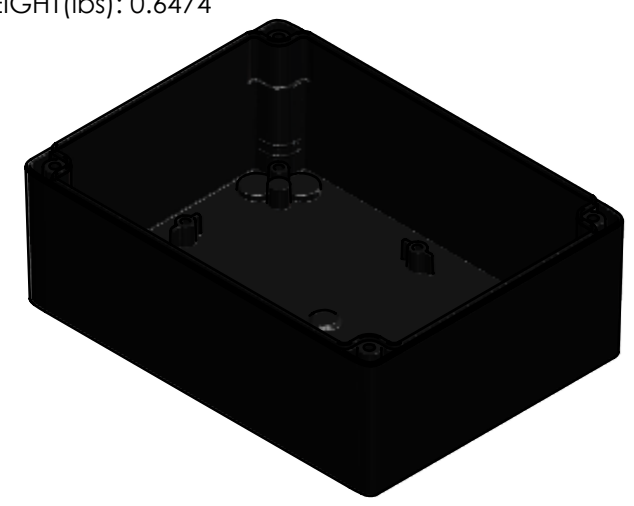

SCALE 1 : 3

- NOTES:
1. REFER TO SOLID MODEL FOR COMPLETE PART DEFINITION.
2. (INSPECTION DIMENSION)
3. EJECTOR PINS TO BE FLUSH ±.015
4. FLASH .005 MAX
5. MAX REGRIND: 20%
6. GATE MUST BE FLUSH OR BELOW ADJACENT SURFACE

REV.	COMMENT	ZONE	REVISED BY	CREATION DATE	UNLESS OTHERWISE SPECIFIED: DIMENSIONS ARE IN: INCHES[mm] TOLERANCES: ANGULAR: ±2° TWO PLACE DECIMAL: ±- THREE PLACE DECIMAL: ±- PRINTED GRAPHICS: ±- PROPRIETARY AND CONFIDENTIAL THE INFORMATION CONTAINED IN THIS DRAWING IS THE SOLE PROPERTY OF POLYCASE. ANY REPRODUCTION IN PART OR AS A WHOLE WITHOUT THE WRITTEN PERMISSION OF POLYCASE IS PROHIBITED. CAD FILE: HN-68BPN	PART NO. AS NOTED MATERIAL PC	FLAME RATING UL94-5VA	SIZE C	SCALE: 1:2	BASE	REV 2	SHEET 1 OF 1
2	REVISED GATE AND OTHER SMALL DETAILS		Douglas French	11/14/2025								
1	REVISED HEIGHT: 2.594 WAS 2.625, LOWERED INSERT LEVEL		Douglas French	4/2/2025								
0			Douglas French	2/26/2025								
REVISIONS					DRAWN CHECKED		NAME D.M.F.	DATE 11/14/2025				