

8 7 6 5 4 3 2 1

BOM Table					
ITEM NO.	PART NO	Rev.	Description	Material	QTY.
1	DR-11R	-.05	DIN RAIL 35mmX7.5mm PER DIN EN 60715 X 100mm	STEEL	1
2	SCREWS-032		#8-16 X 5/16 PLASTITE, PAN HEAD, PHILLIPS	ZINC STEEL	2
3	W-015		#8 SAE WASHER, SST	SST	2

D

D

C

C

B

B

A

A

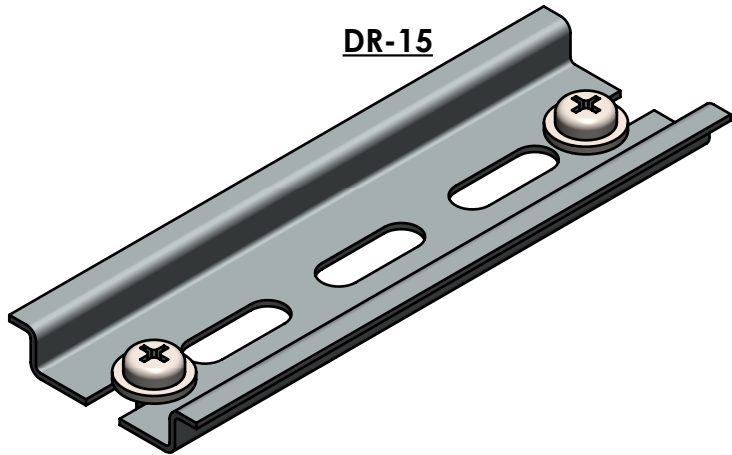
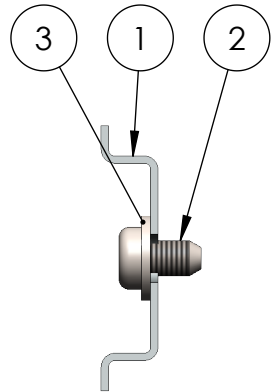
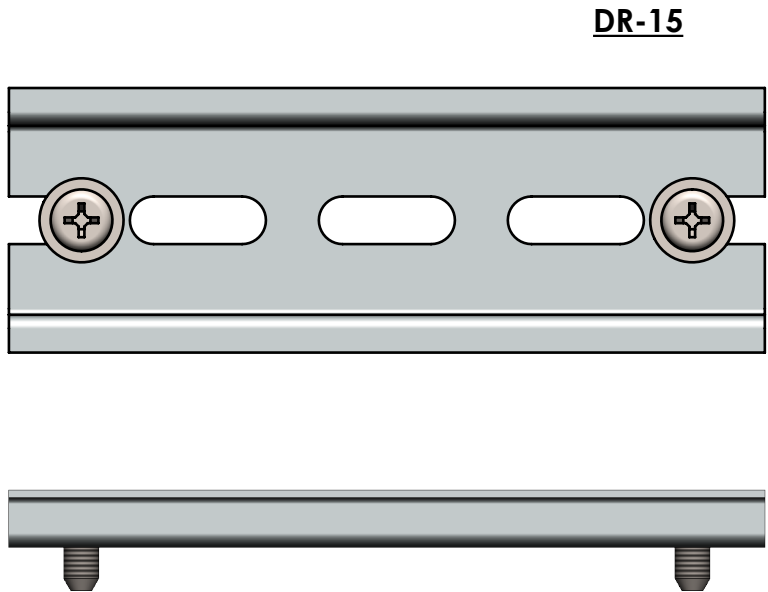

DR-15

DR-15

UNLESS OTHERWISE SPECIFIED:
 DIMENSIONS ARE IN: INCHES[mm]
 TOLERANCES: ANGULAR: ±2°
 TWO PLACE DECIMAL: ±.010
 THREE PLACE DECIMAL: ±.005
 PRINTED GRAPHICS: ±.010

PROPRIETARY AND CONFIDENTIAL
 THE INFORMATION CONTAINED IN THIS
 DRAWING IS THE SOLE PROPERTY OF
 POLYCASE. ANY REPRODUCTION IN PART
 OR AS A WHOLE WITHOUT THE WRITTEN
 PERMISSION OF POLYCASE IS PROHIBITED.
 CAD FILE: DR-15

PART NO.
DR-15
 MATERIAL

FLAME RATING
 SIZE
B
 DRAWN D.M.F. 3/19/2021
 CHECKED - 4/9/2020

polycase
 1305 CHESTER IND. PARKWAY AVON, OHIO 44011-1083 U.S.A.
 PH#: 1-800-248-1233, 440-934-0444 FAX#: 440-934-0088

DIN RAIL KIT
 REV
 -
 SCALE: 1:1
 SHEET 1 OF 1

REV.	DESCRIPTION	ZONE	BY	APPR'D	DATE
REVISIONS					

8 7 6 5 4 3 2 1