

BOM Table						
ITEM NO.	PART NUMBER	Rev.	Description	Material	Color	QTY.
1	SG-22B-02	-	BASE	PC	LIGHT GRAY	1
2	SG-22C-02	-	COVER	PC	LIGHT GRAY	1
3	SG-KIT-02	-01	HARDWARE KIT			1
3.1	SCREWS-019	-01	M3.85x1.8 SPAX X 44mm LG, PAN HEAD, PHILLIPS	304 SST		4
3.2	SCREWS-022	-01	M3.85x1.8 SPAX X 9mm LG, PAN HEAD, PHILLIPS	QS136-3		4
3.3	SG-97S	-	RETAINER STRAP	PA6	GRAY	2

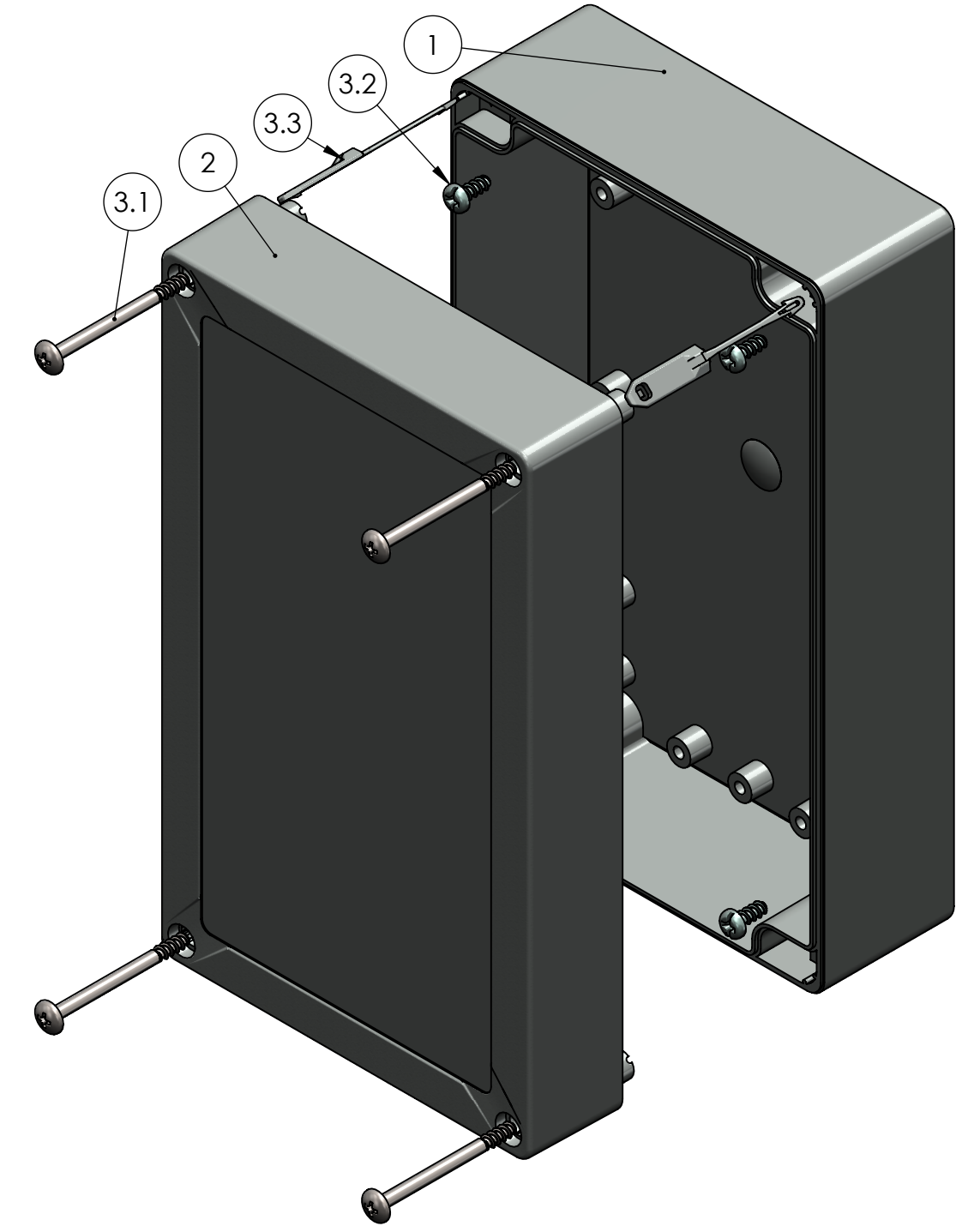

PART NUMBER: SG-22-02
 FLAME RATING: 5VA per UL50/UL746C

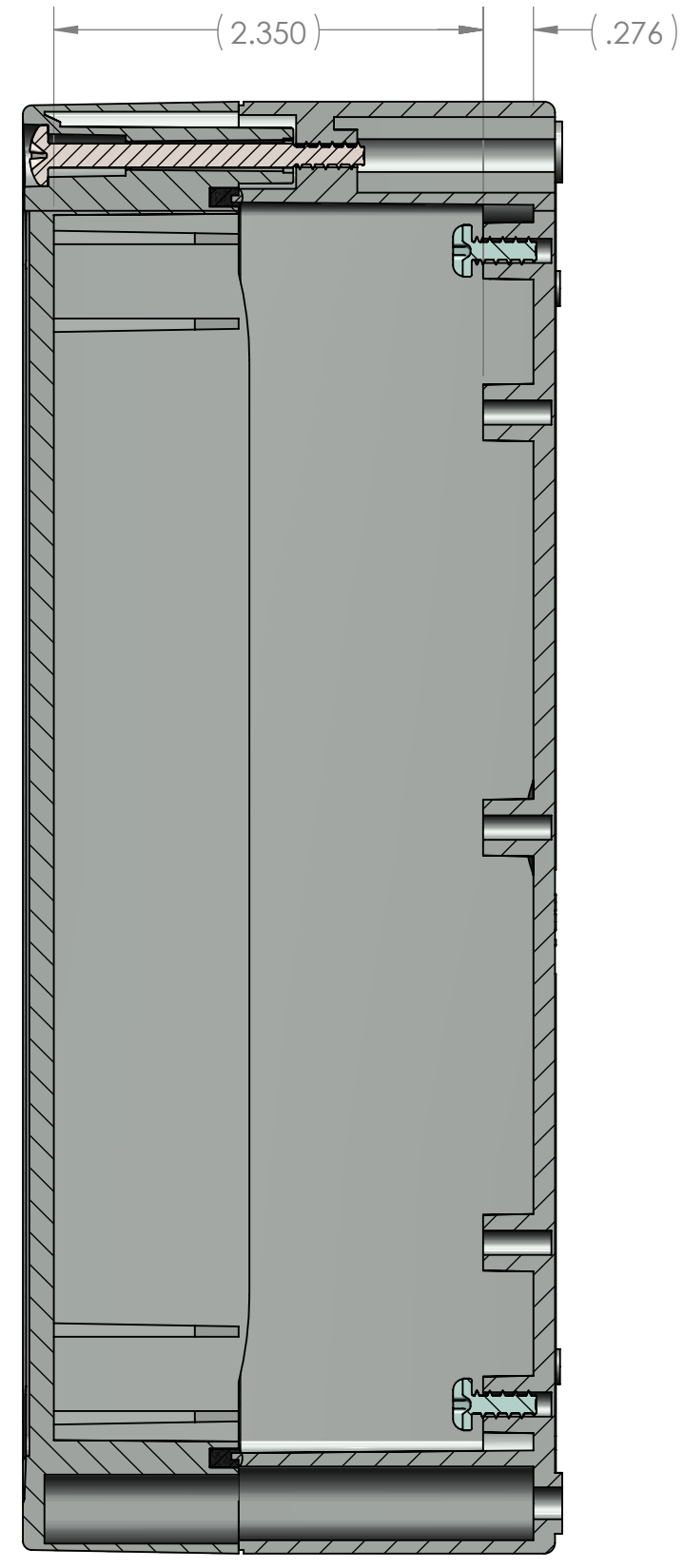
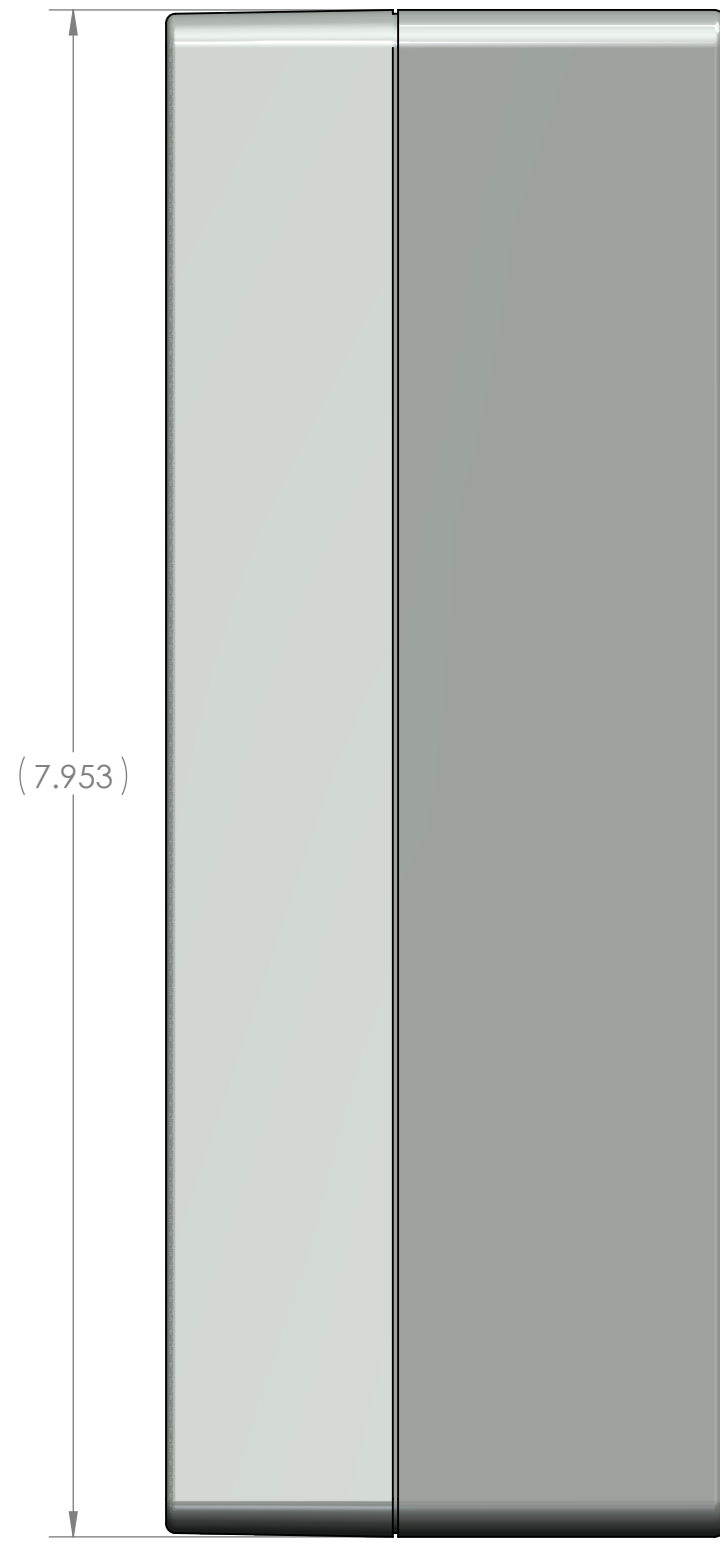
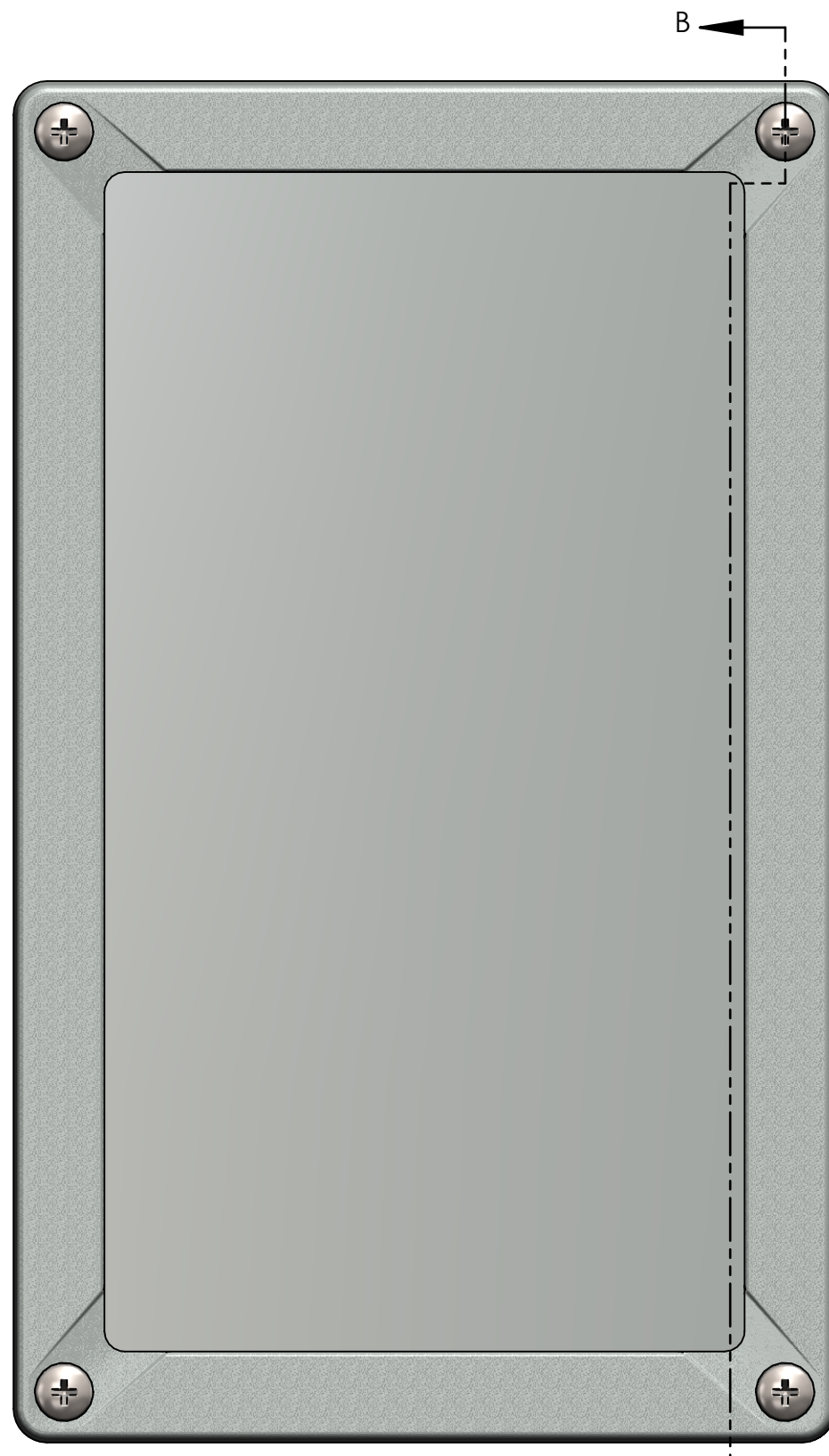
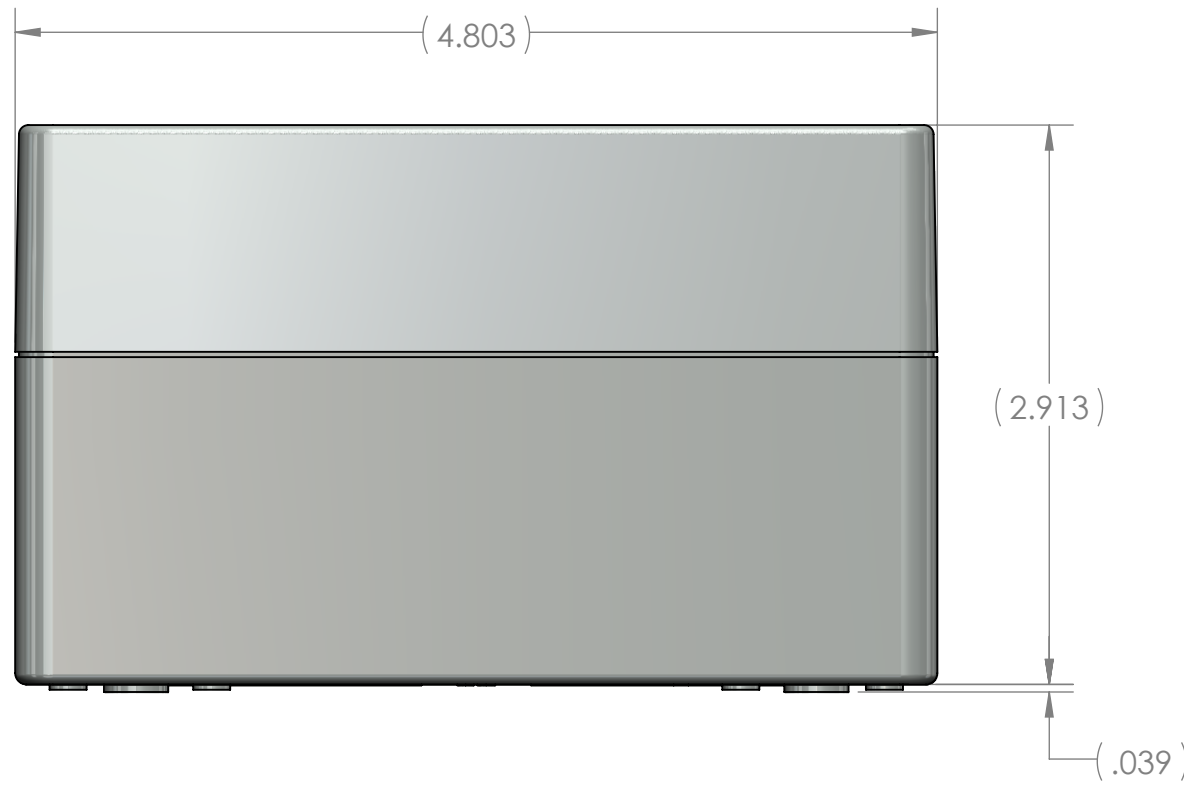

UNLESS OTHERWISE SPECIFIED:
 DIMENSIONS ARE IN: INCHES[mm]
 TOLERANCES: ANGULAR: ±2°
 TWO PLACE DECIMAL: ±
 THREE PLACE DECIMAL: ±
 PRINTED GRAPHICS: ±0.10

PROPRIETARY AND CONFIDENTIAL
 THE INFORMATION CONTAINED IN THIS
 DRAWING IS THE SOLE PROPERTY OF
 POLYCASE. ANY REPRODUCTION IN PART
 OR AS A WHOLE WITHOUT THE WRITTEN
 PERMISSION OF POLYCASE IS PROHIBITED.
 CAD FILE: SG-22

PART NO. SEE BOM
 MATERIAL

FLAME RATING

SIZE C

SCALE: 1:1

1305 CHESTER RD. PARKWAY AVON, OHIO 44011-1083 U.S.A.
 PH: 1-800-248-1233 440-934-0444 FAX: 440-934-0088

REV

REV.	DESCRIPTION	ZONE	BY	APPR'D	DATE
REVISIONS					

DRAWN: NAME DATE
 CHECKED: D.M.F. 10/9/2017
 C.C.B. 10/10/2017

SHEET 1 OF 2

8 7 6 5 4 3 2 1

BOM Table						
ITEM NO.	PART NUMBER	Rev.	Description	Material	Color	QTY.
1	SG-22B-02	-	BASE	PC	LIGHT GRAY	1
2	SG-22C-03	-	COVER	PC	CLEAR	1
3	SG-KIT-02	-.01	HARDWARE KIT			1
3.1	SCREWS-019	-.01	M3.85x1.8 SPAX X 44mm LG, PAN HEAD, PHILLIPS	304 SST		4
3.2	SCREWS-022	-.01	M3.85x1.8 SPAX X 9mm LG, PAN HEAD, PHILLIPS	QSt36-3		4
3.3	SG-97S	-	RETAINER STRAP	PA6	GRAY	2

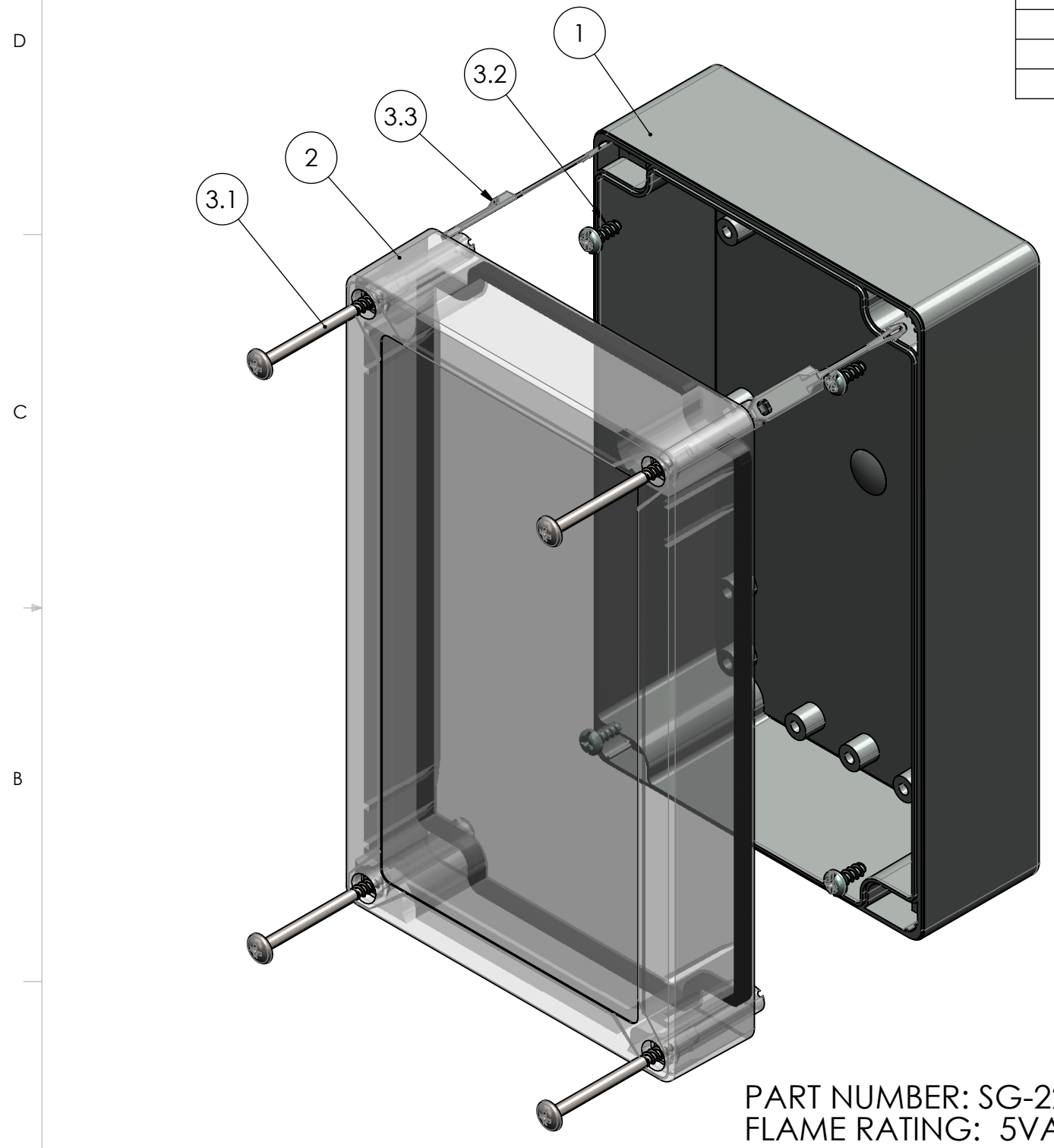

PART NUMBER: SG-22-03
 FLAME RATING: 5VA per UL50/UL746C

UNLESS OTHERWISE SPECIFIED: DIMENSIONS ARE IN: INCHES[mm] TOLERANCES: ANGULAR: ±2° TWO PLACE DECIMAL: ± THREE PLACE DECIMAL: ± PRINTED GRAPHICS: ±.010	PART NO. SEE BOM		 1305 CHESTER IND. PARKWAY AVON, OHIO 44011-1083 U.S.A. PH#: 1-800-248-1233, 440-934-0444 FAX#: 440-934-0088
	MATERIAL		
PROPRIETARY AND CONFIDENTIAL THE INFORMATION CONTAINED IN THIS DRAWING IS THE SOLE PROPERTY OF POLYCASE. ANY REPRODUCTION IN PART OR AS A WHOLE WITHOUT THE WRITTEN PERMISSION OF POLYCASE IS PROHIBITED. CAD FILE: SG-22	FLAME RATING	SIZE B	REV -
	DRAWN	NAME	DATE
	CHECKED	C.C.B.	10/10/2017
SCALE: 1:1.5		SHEET 2 OF 2	

8 7 6 5 4 3 2 1

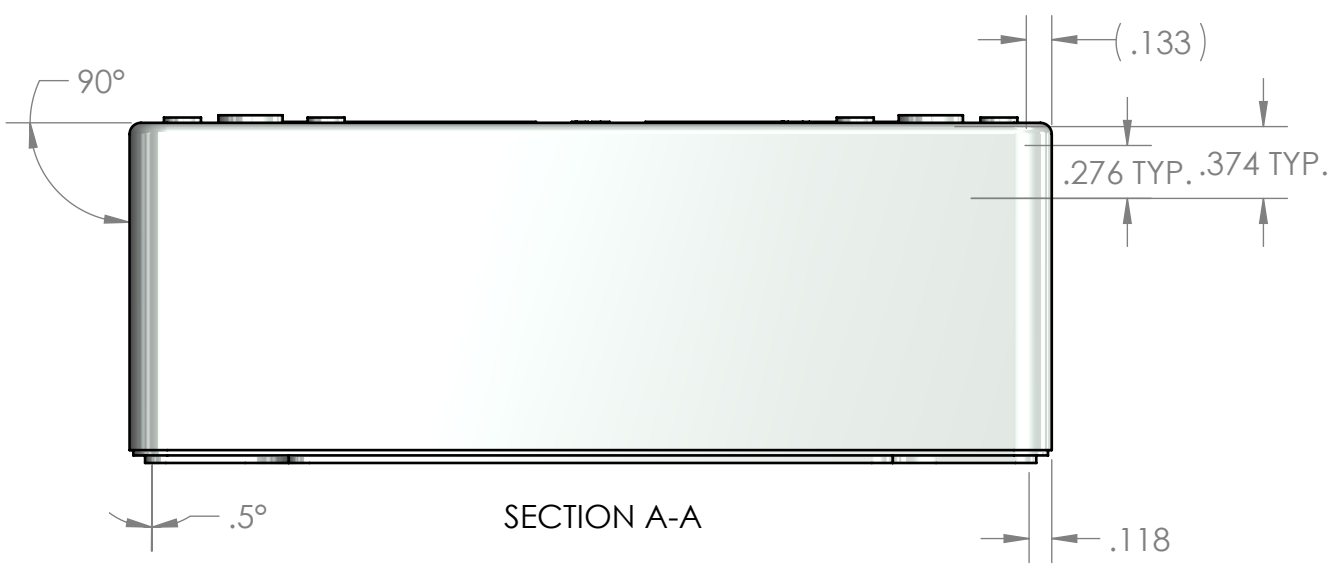

PART NUMBER: SG-22B-02
 COLOR: LIGHT GRAY

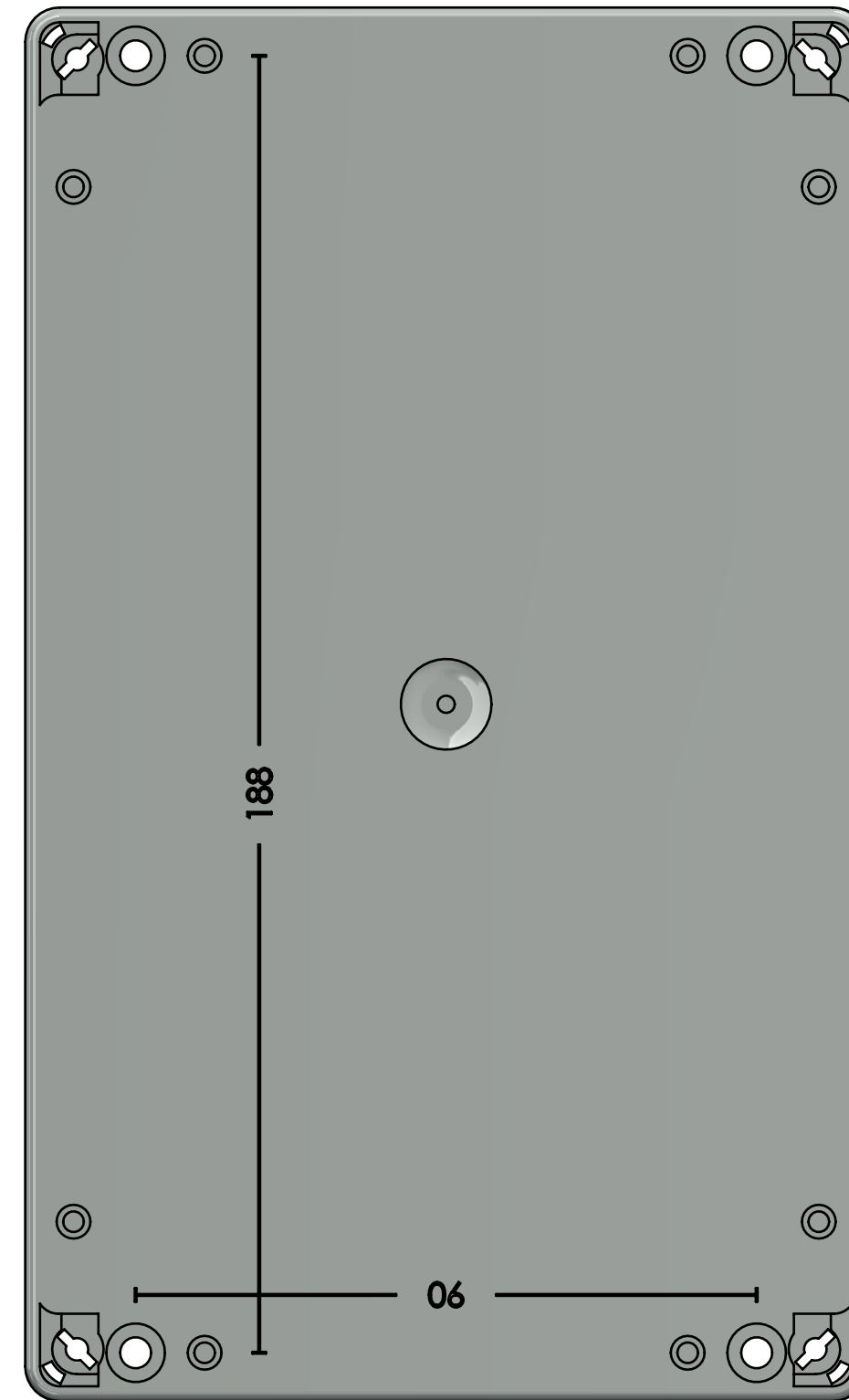
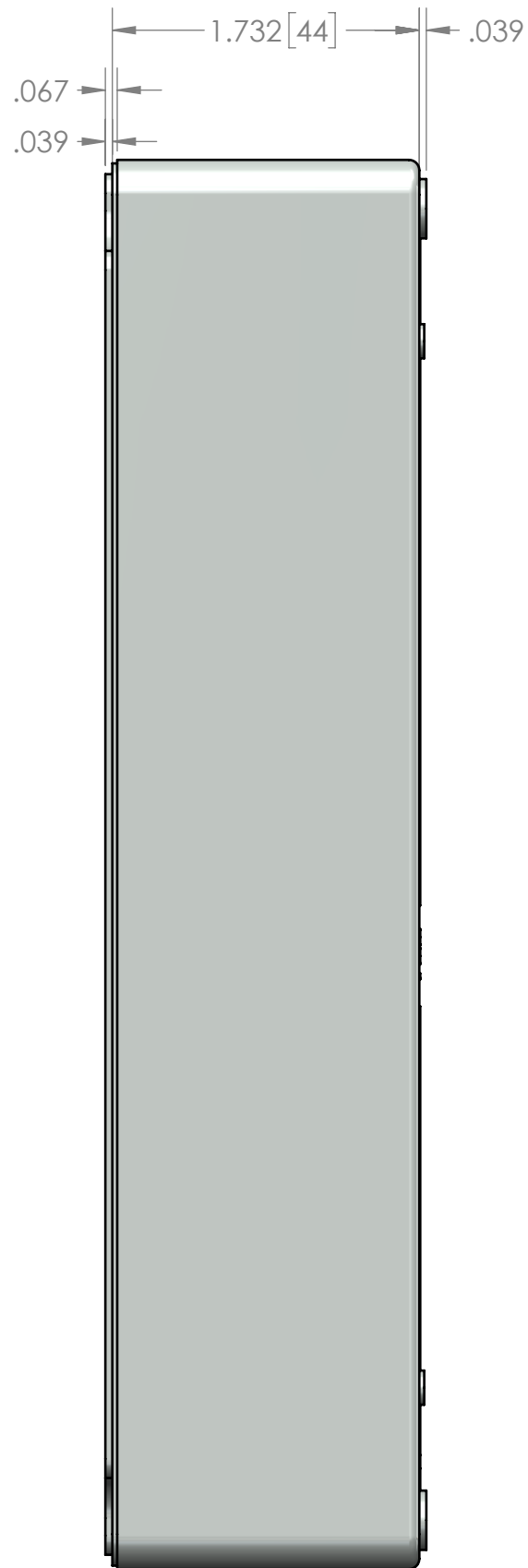
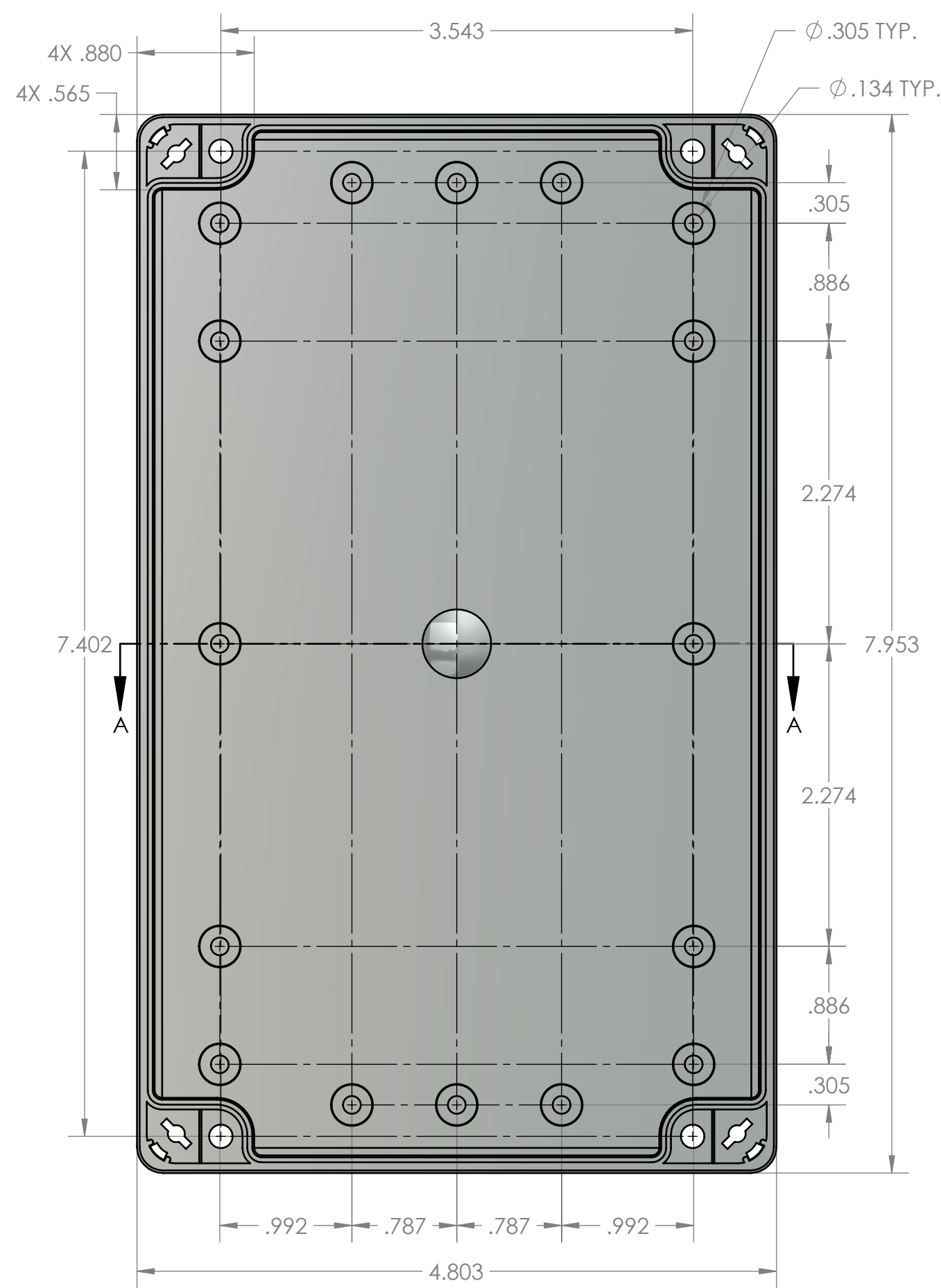
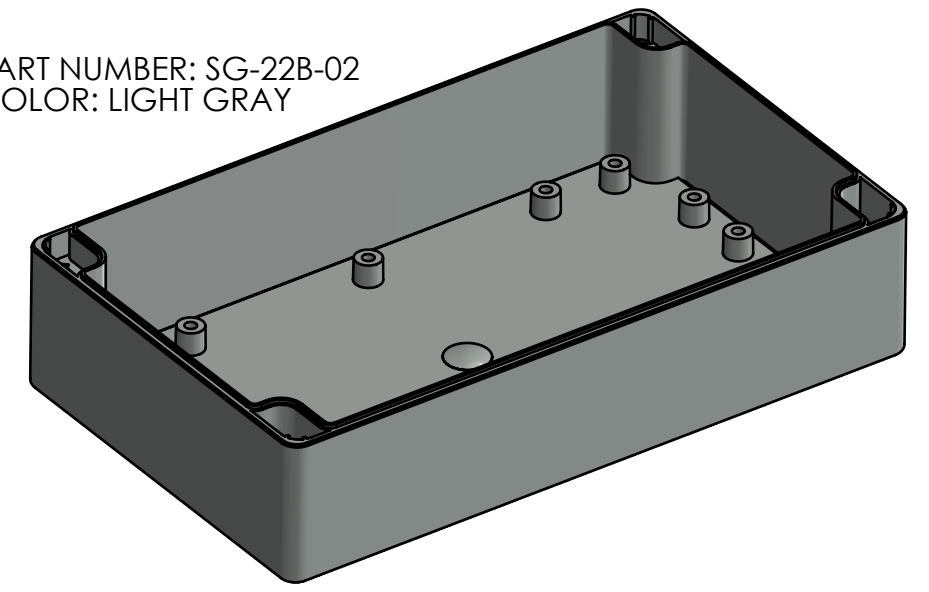

UNLESS OTHERWISE SPECIFIED: DIMENSIONS ARE IN: INCHES[mm] TOLERANCES: ANGULAR: ±2° TWO PLACE DECIMAL: ± THREE PLACE DECIMAL: ± PRINTED GRAPHICS: ±.010		PART NO. SG-22B-02			
PROPRIETARY AND CONFIDENTIAL THE INFORMATION CONTAINED IN THIS DRAWING IS THE SOLE PROPERTY OF POLYCASE. ANY REPRODUCTION IN PART OR AS A WHOLE WITHOUT THE WRITTEN PERMISSION OF POLYCASE IS PROHIBITED. CAD FILE: SG-22B		MATERIAL PC			
REV. DESCRIPTION ZONE BY APPR'D DATE		FLAME RATING		SIZE C	REV -02
REVISIONS		DRAWN CHECKED		SCALE: 1:1	SHEET 1 OF 1

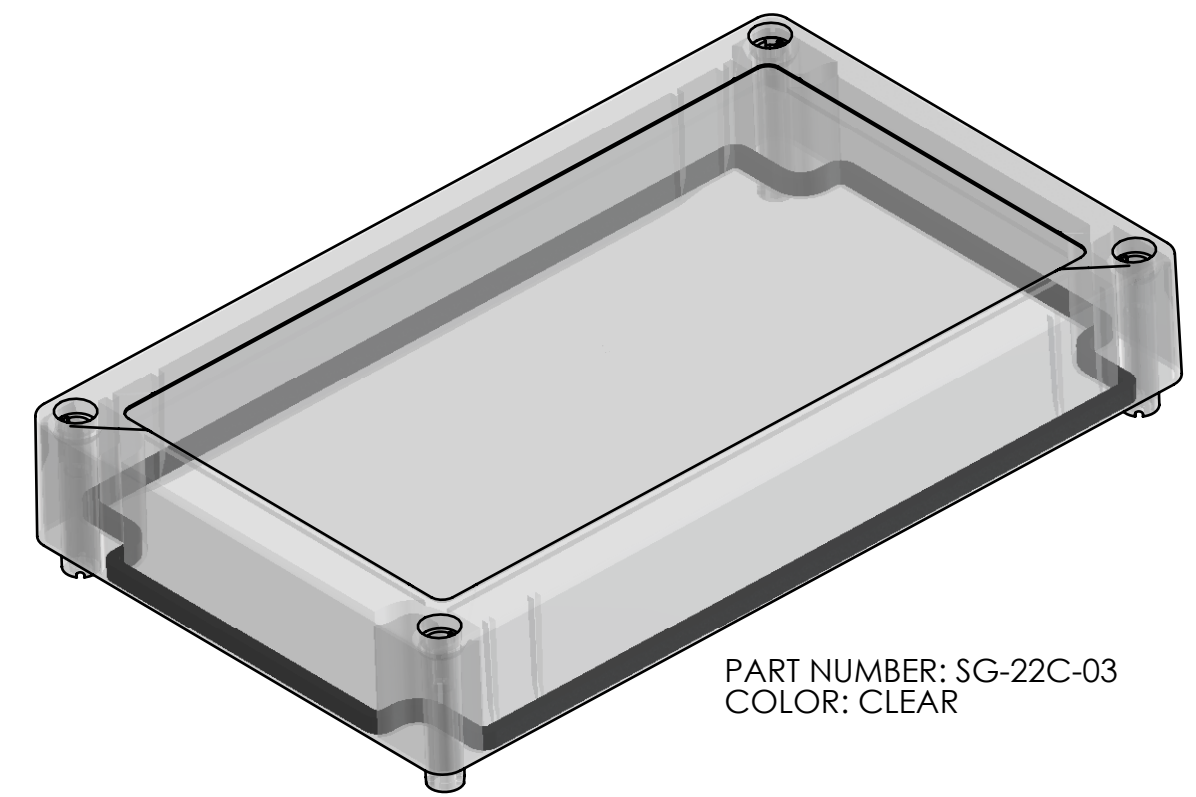
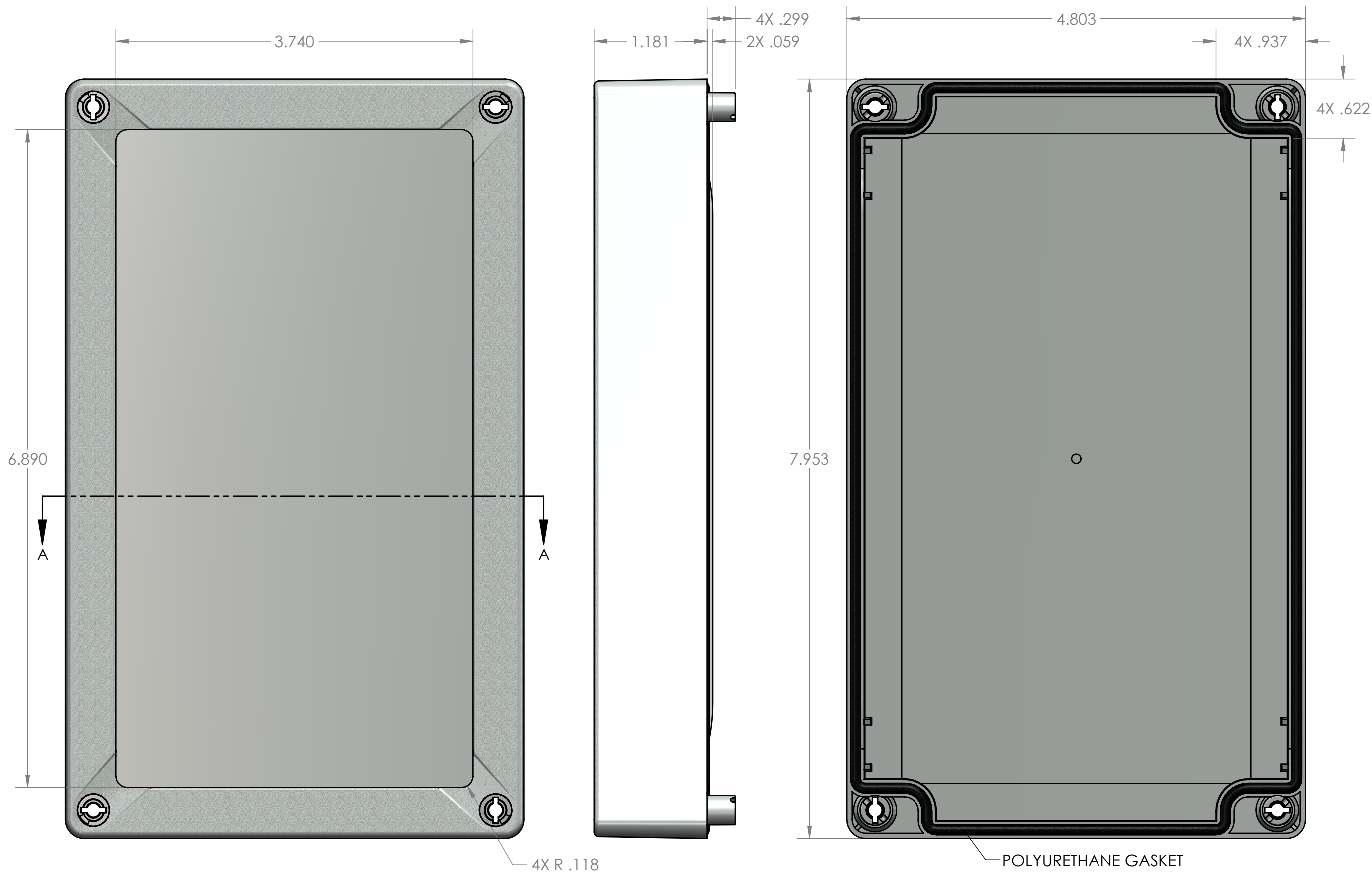
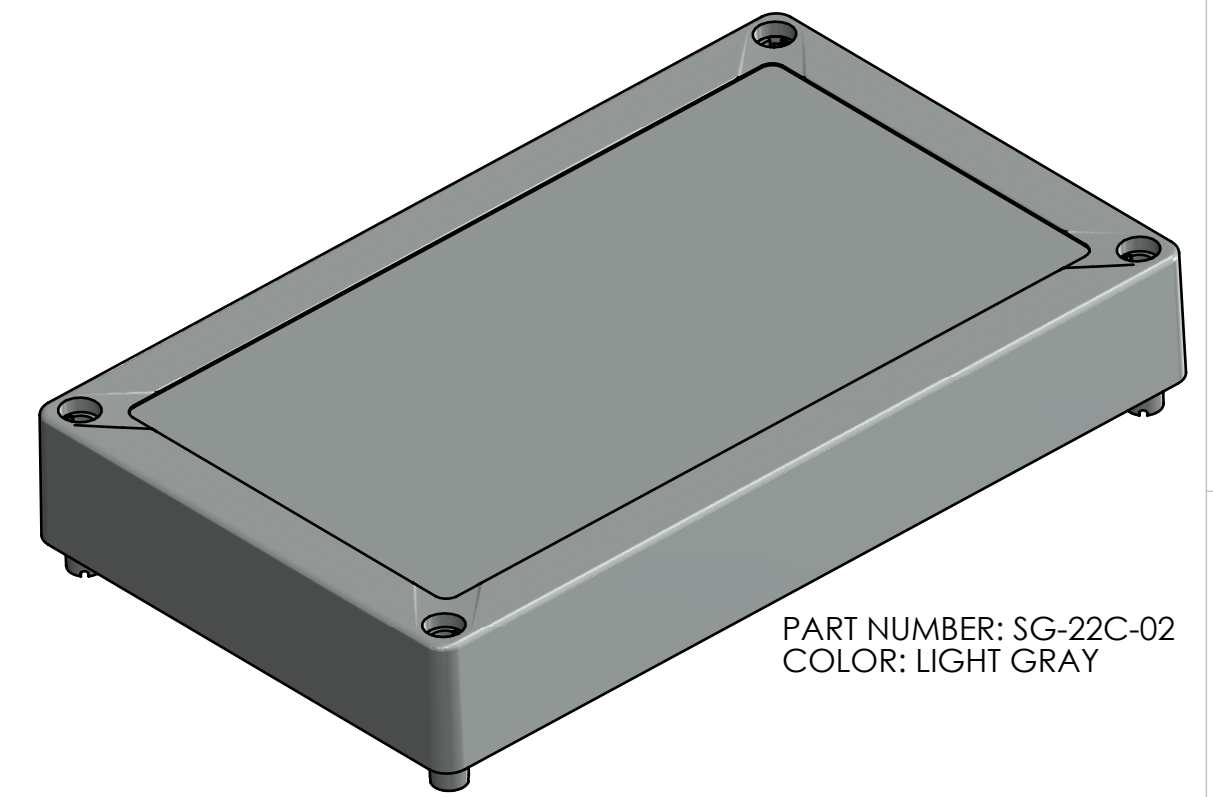
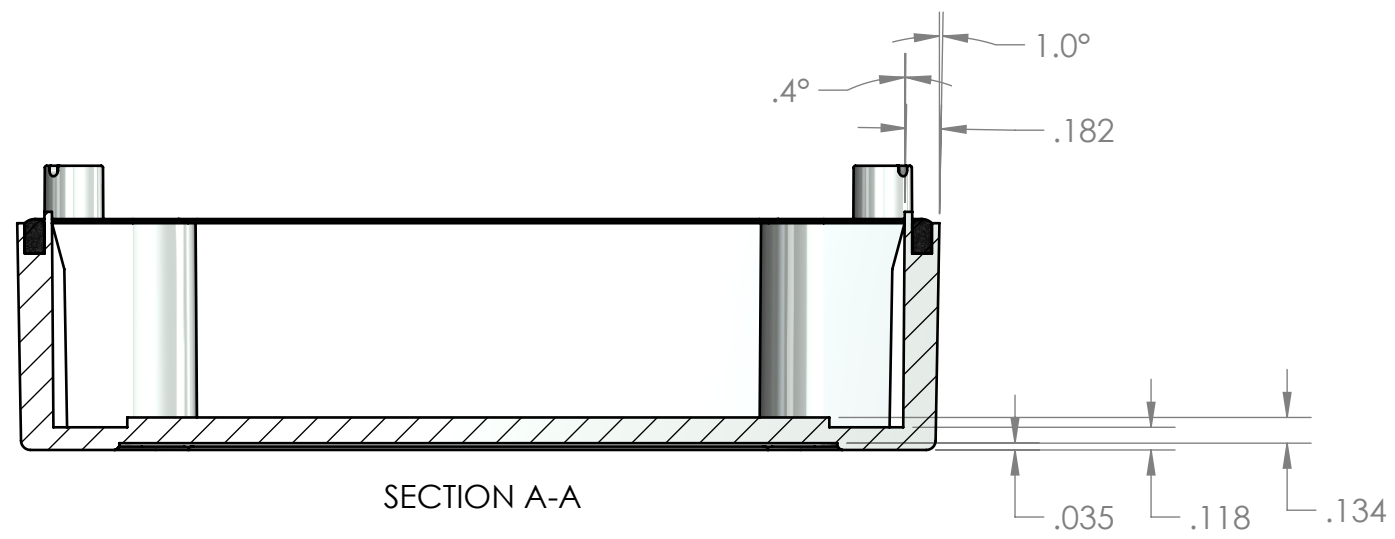

UNLESS OTHERWISE SPECIFIED: DIMENSIONS ARE IN: INCHES[mm] TOLERANCES: ANGULAR: ±2° TWO PLACE DECIMAL: ± THREE PLACE DECIMAL: ± PRINTED GRAPHICS: ±.010		PART NO. SG-22C		 <small>1305 CHESTER RD. PARKWAY AVON, OHIO 44011-1083 U.S.A. PH: 1-800-248-1233 440-934-0444 FAX: 440-934-0088</small>	
PROPRIETARY AND CONFIDENTIAL THE INFORMATION CONTAINED IN THIS DRAWING IS THE SOLE PROPERTY OF POLYCASE. ANY REPRODUCTION IN PART OR AS A WHOLE WITHOUT THE WRITTEN PERMISSION OF POLYCASE IS PROHIBITED. CAD FILE: SG-22C		MATERIAL PC			
DRAWN		NAME	DATE	SCALE: 1:1	
CHECKED		D.M.F.	10/9/2017	REV -02	
		C.C.B.	10/10/2017	SHEET 1 OF 1	