

BOM Table						
ITEM NO.	PART NUMBER	Rev.	Description	Material	Color	QTY.
1	SK-15B-02	-	BASE	GFR/PC	LIGHT GRAY	1
2	SK-26C-02	-	COVER	PC-GFR	LIGHT GRAY	1
3	SK-KIT-05	-	HARDWARE KIT			1
3.1	SCREWS-016	-	ASSEMBLY FASTENER	GFR/PA6	GRAY	4
3.2	SK-CAP-02	-	SCREW HEAD CAP		CLEAR	4

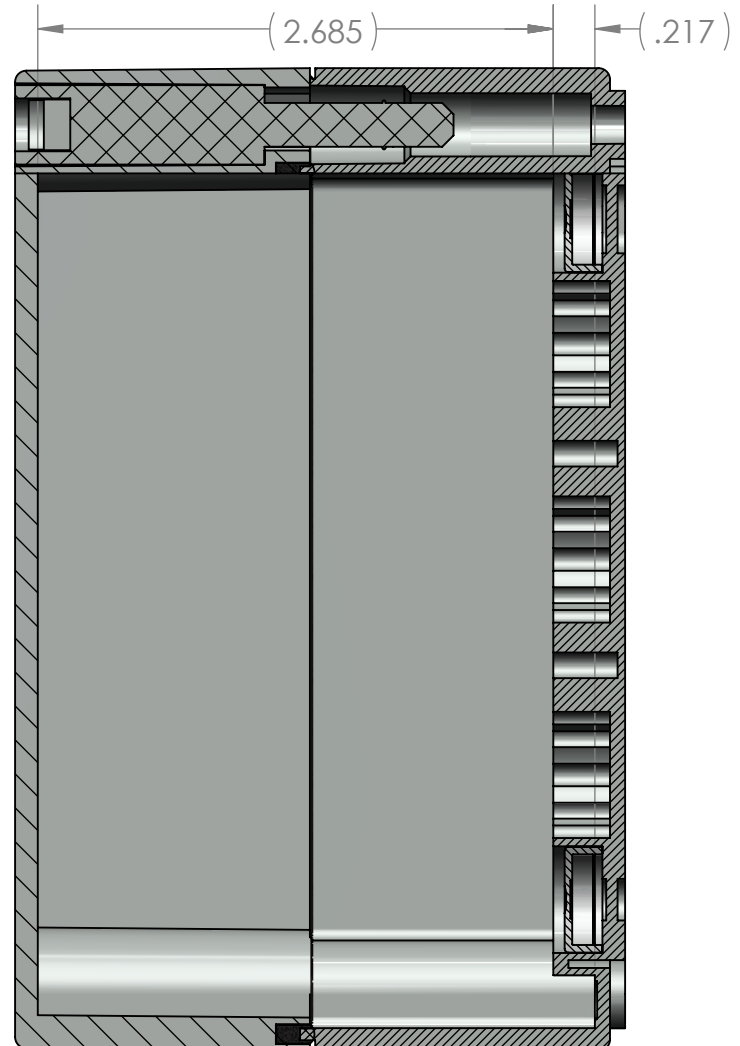

SECTION B-B

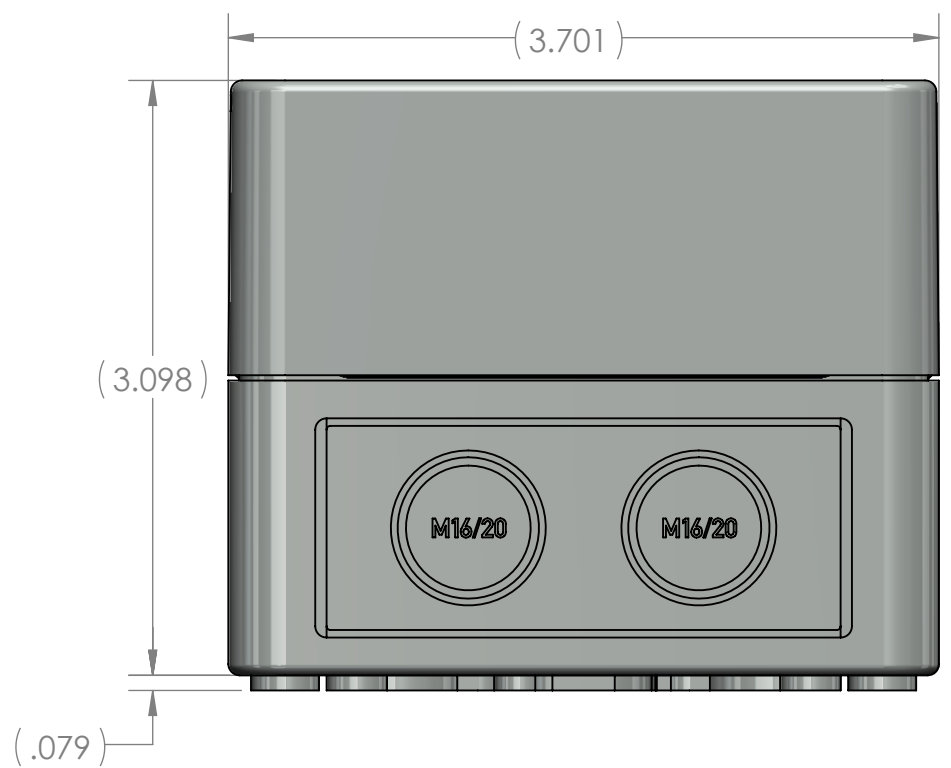
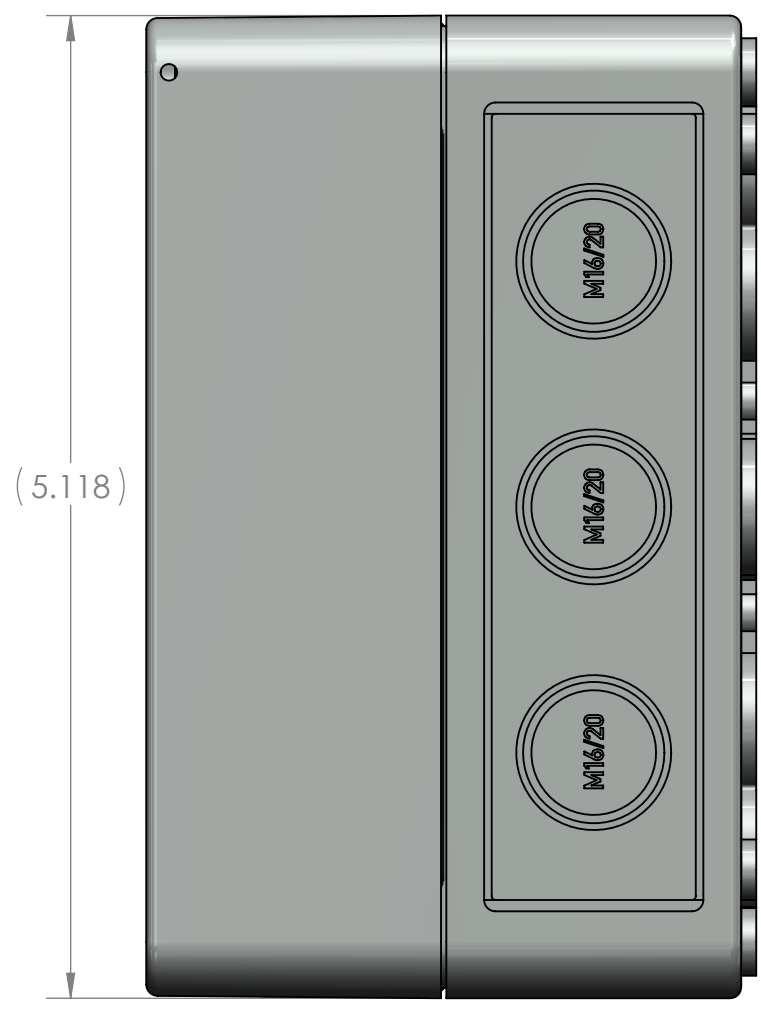
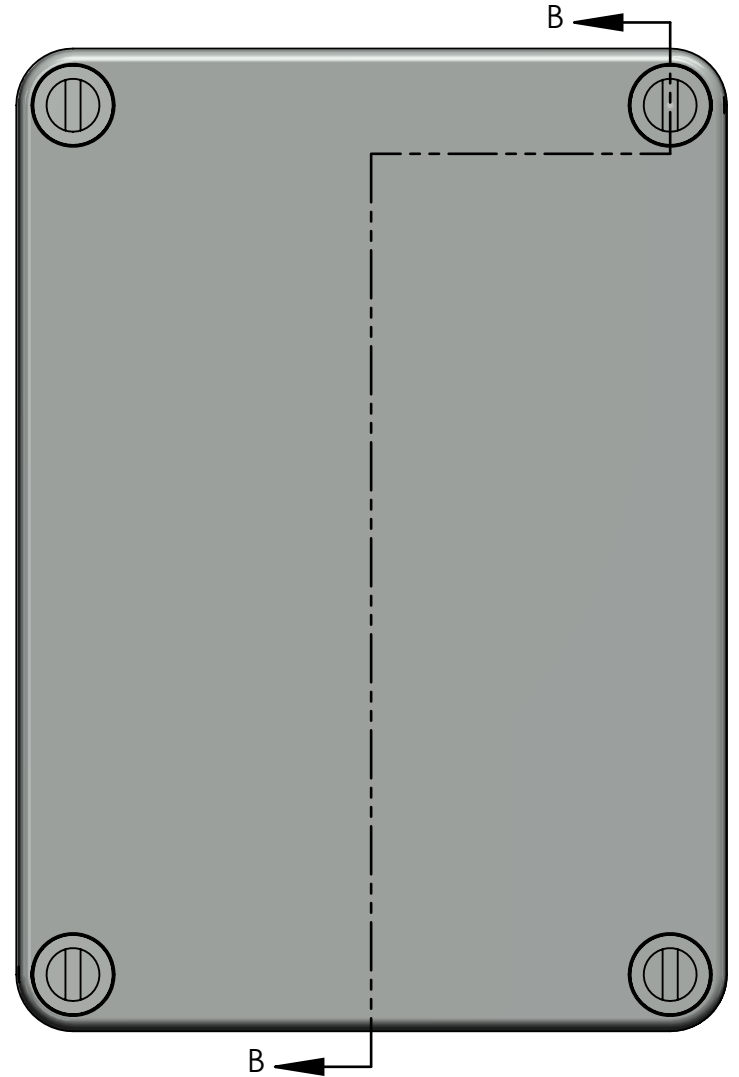
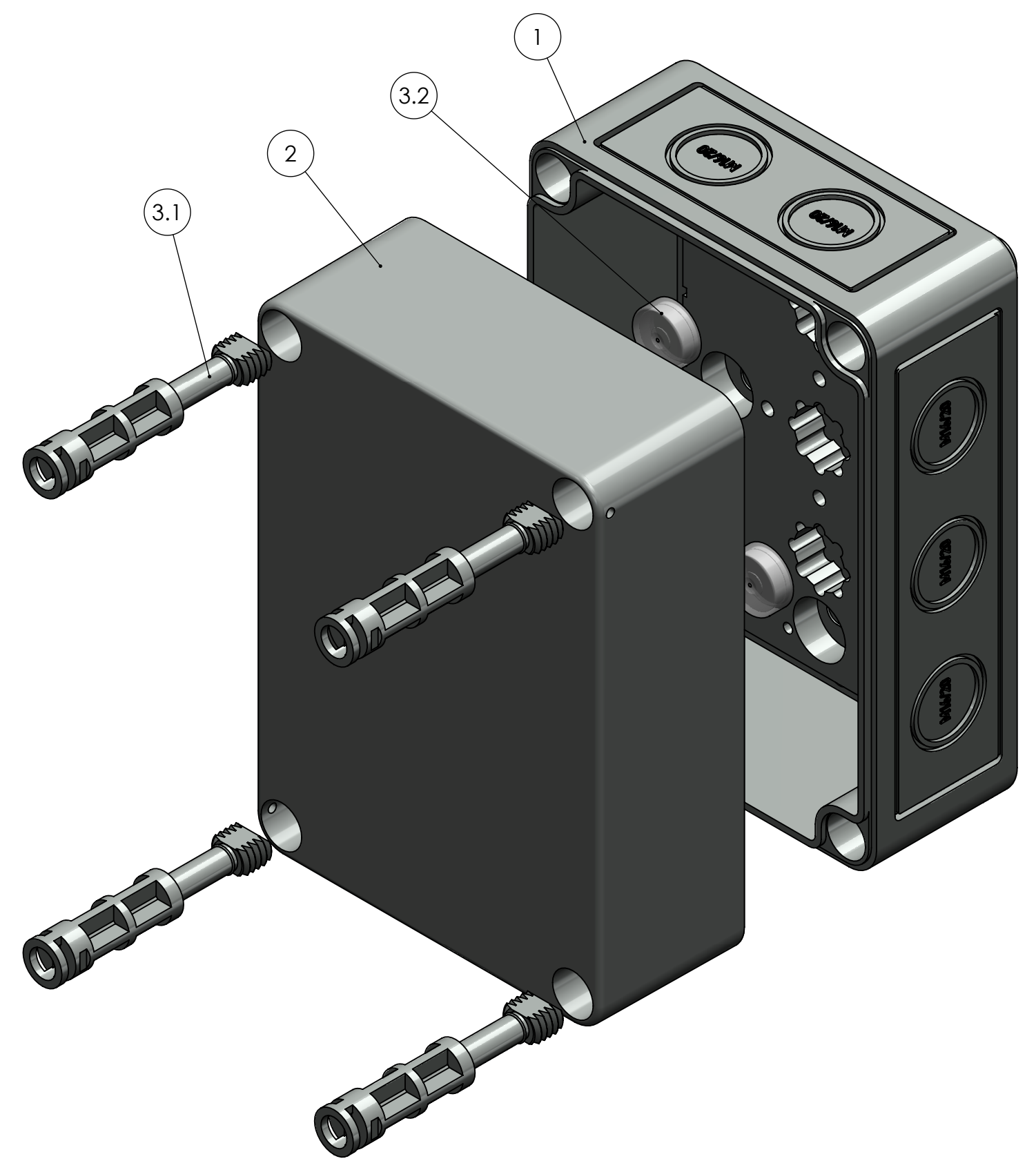

PART NUMBER: SK-26-02
 FLAME RATING: 5VA per UL50/UL746C

UNLESS OTHERWISE SPECIFIED: DIMENSIONS ARE IN: INCHES[mm] TOLERANCES: ANGULAR: ±2° TWO PLACE DECIMAL: ± THREE PLACE DECIMAL: ± PRINTED GRAPHICS: ±0.10		PART NO. SEE BOM		 <small>1305 CHESTER RD. PARKWAY AVON, OHIO 44011-1083 U.S.A. PH: 1-800-248-1233, 440-934-0444 FAX: 440-934-0088</small>	
<small>PROPRIETARY AND CONFIDENTIAL THE INFORMATION CONTAINED IN THIS DRAWING IS THE SOLE PROPERTY OF POLYCASE. ANY REPRODUCTION IN PART OR AS A WHOLE WITHOUT THE WRITTEN PERMISSION OF POLYCASE IS PROHIBITED. CAD FILE: SK-26</small>		FLAME RATING SIZE C			
REV.	DESCRIPTION	ZONE	BY	APPR'D	DATE
REVISIONS					
DRAWN		NAME	DATE	SCALE: 1:1	
CHECKED		D.M.F.	10/10/2017	SHEET 1 OF 2	
			9/8/2015		

8 7 6 5 4 3 2 1

BOM Table						
ITEM NO.	PART NUMBER	Rev.	Description	Material	Color	QTY.
1	SK-15B-02	-	BASE	GFR/PC	LIGHT GRAY	1
2	SK-26C-03	-	COVER	PC	CLEAR	1
3	SK-KIT-06	-	HARDWARE KIT			1
3.1	SCREWS-017	-	ASSEMBLY FASTENER	GFR/PA6	BLACK	4
3.2	SK-CAP-02	-	SCREW HEAD CAP		CLEAR	4

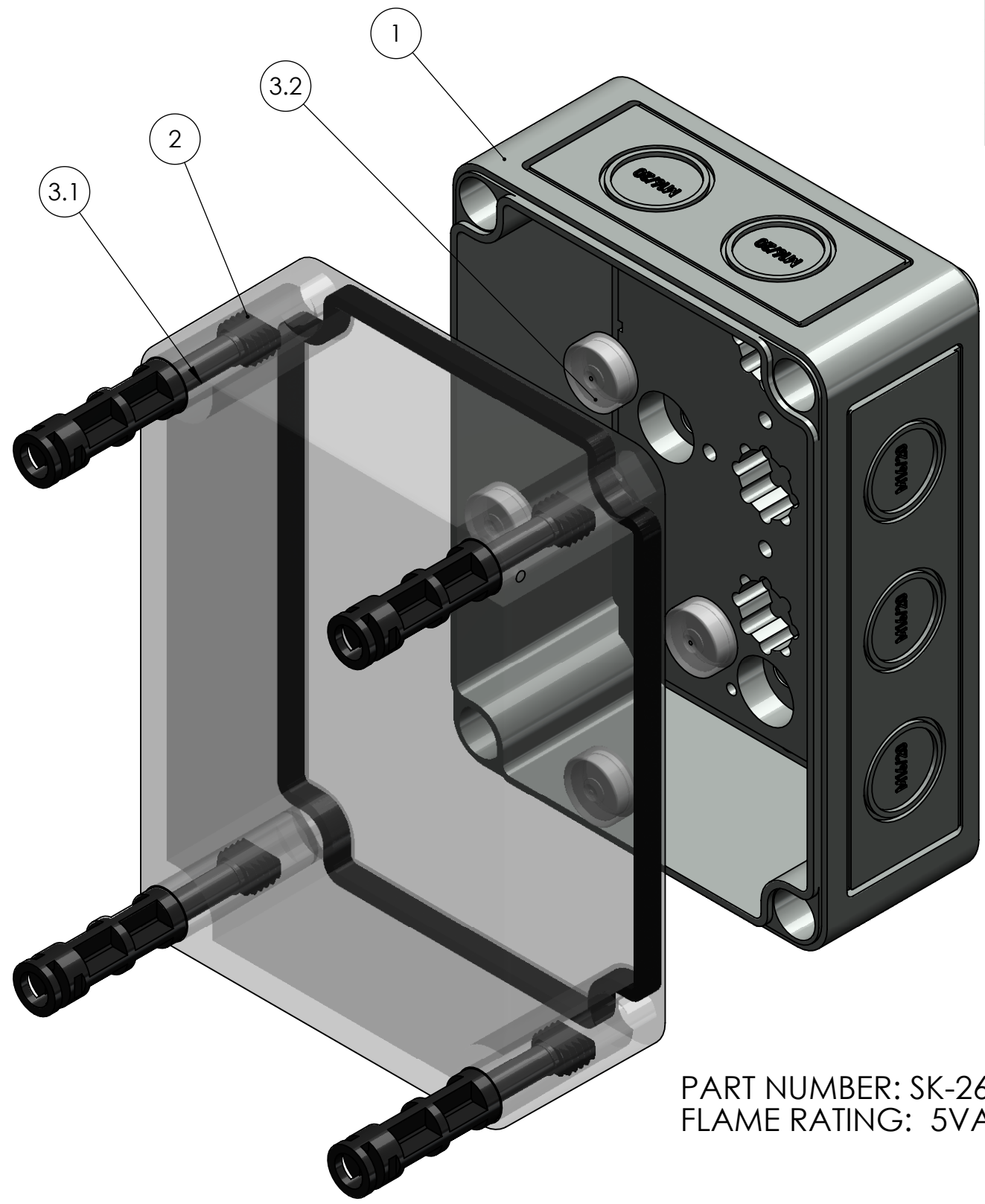

PART NUMBER: SK-26-03
 FLAME RATING: 5VA per UL50/UL746C

D
C
B
A

D
C
B
A

UNLESS OTHERWISE SPECIFIED: DIMENSIONS ARE IN: INCHES[mm] TOLERANCES: ANGULAR: ±2° TWO PLACE DECIMAL: ± THREE PLACE DECIMAL: ± PRINTED GRAPHICS: ±.010 PROPRIETARY AND CONFIDENTIAL THE INFORMATION CONTAINED IN THIS DRAWING IS THE SOLE PROPERTY OF POLYCASE. ANY REPRODUCTION IN PART OR AS A WHOLE WITHOUT THE WRITTEN PERMISSION OF POLYCASE IS PROHIBITED. CAD FILE: SK-26	PART NO. SEE BOM		 <small>1305 CHESTER IND. PARKWAY AVON, OHIO 44011-1083 U.S.A. PH#: 1-800-248-1233, 440-934-0444 FAX#: 440-934-0088</small>	
	MATERIAL			
	FLAME RATING		SIZE B	REV -
	DRAWN	NAME	DATE	SCALE: 1:1
CHECKED	D.M.F.	10/10/2017 9/8/2015		

8 7 6 5 4 3 2 1

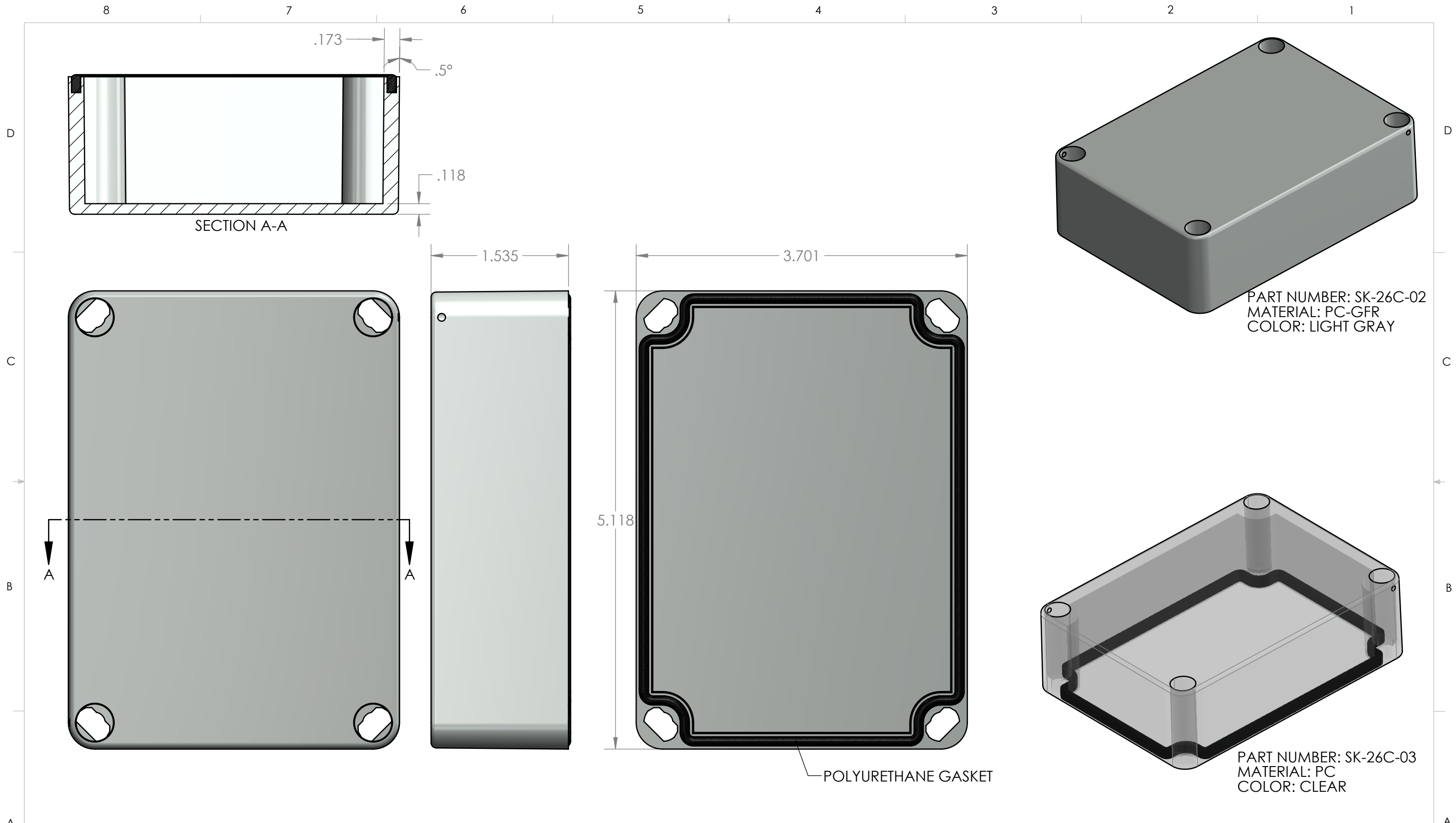

UNLESS OTHERWISE SPECIFIED: DIMENSIONS ARE IN: INCHES[mm] TOLERANCES: ANGULAR: ±2° TWO PLACE DECIMAL: ± THREE PLACE DECIMAL: ± PRINTED GRAPHICS: ±.010		PART NO. SK-26C		 <small>1305 CHESTER IND. PARKWAY AVON, OHIO 44011-1083 U.S.A. PH#: 1-800-248-1233, 440-934-0444 FAX#: 440-934-0088</small>			
PROPRIETARY AND CONFIDENTIAL THE INFORMATION CONTAINED IN THIS DRAWING IS THE SOLE PROPERTY OF POLYCASE. ANY REPRODUCTION IN PART OR AS A WHOLE WITHOUT THE WRITTEN PERMISSION OF POLYCASE IS PROHIBITED. CAD FILE: SK-26C		MATERIAL -				FLAME RATING -	SIZE B
REV.	DESCRIPTION	ZONE	BY	APPR'D	DATE	COVER	REV
	REVISIONS					SCALE: 1:1	SHEET 1 OF 1

REV.	DESCRIPTION	ZONE	BY	APPR'D	DATE
	REVISIONS				

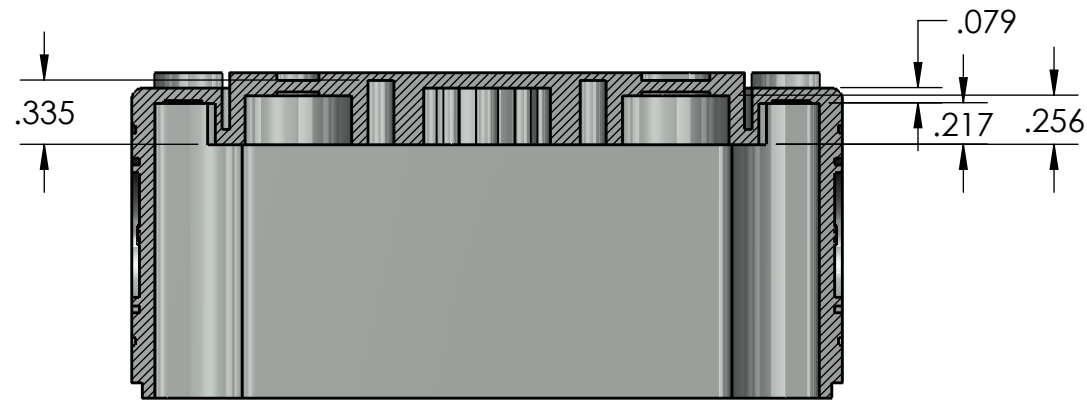

SECTION A-A

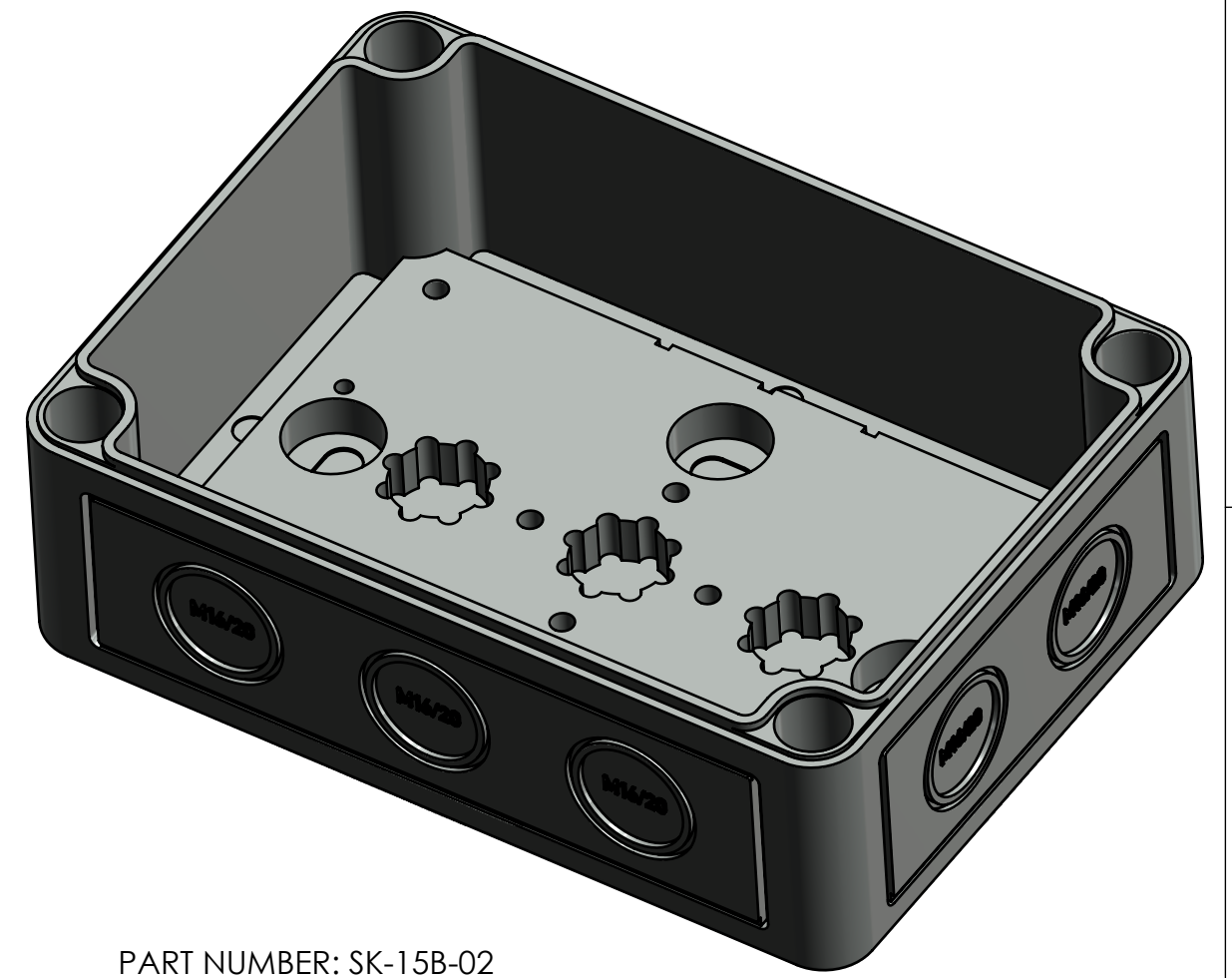
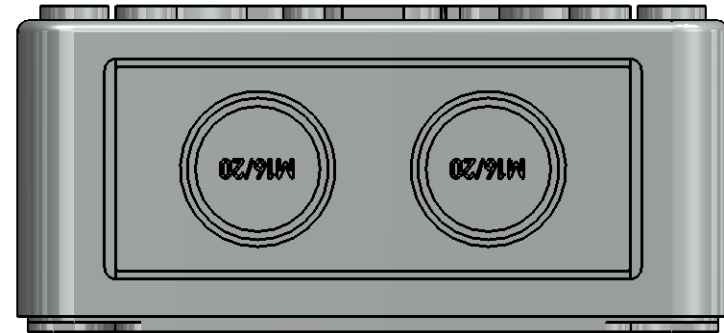

PART NUMBER: SK-15B-02
COLOR: LIGHT GRAY

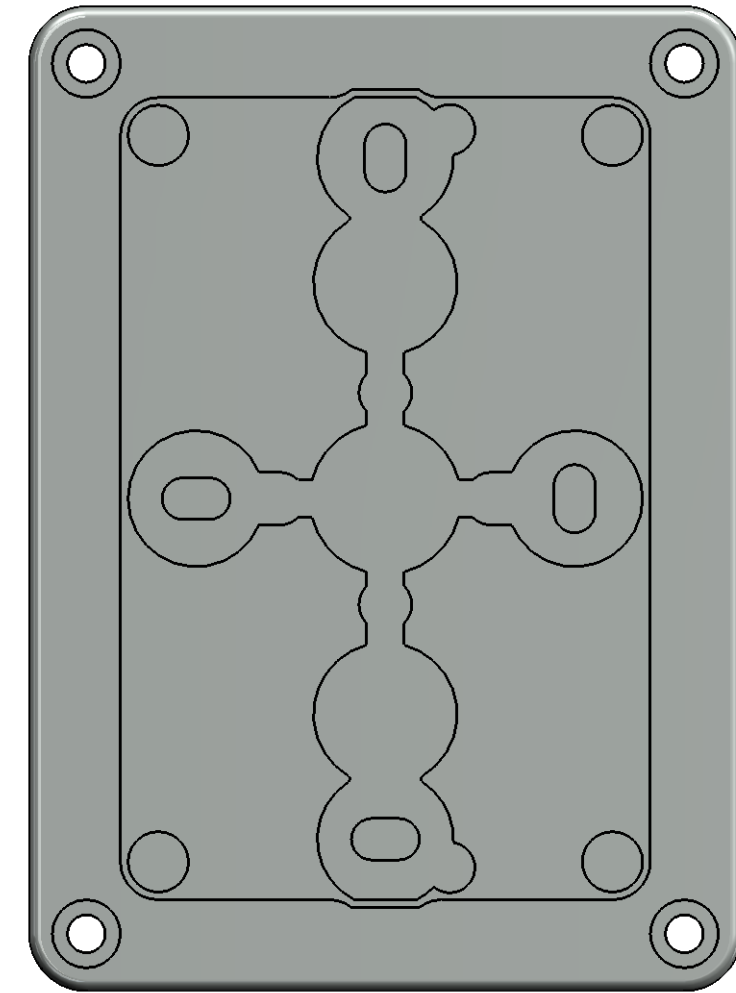
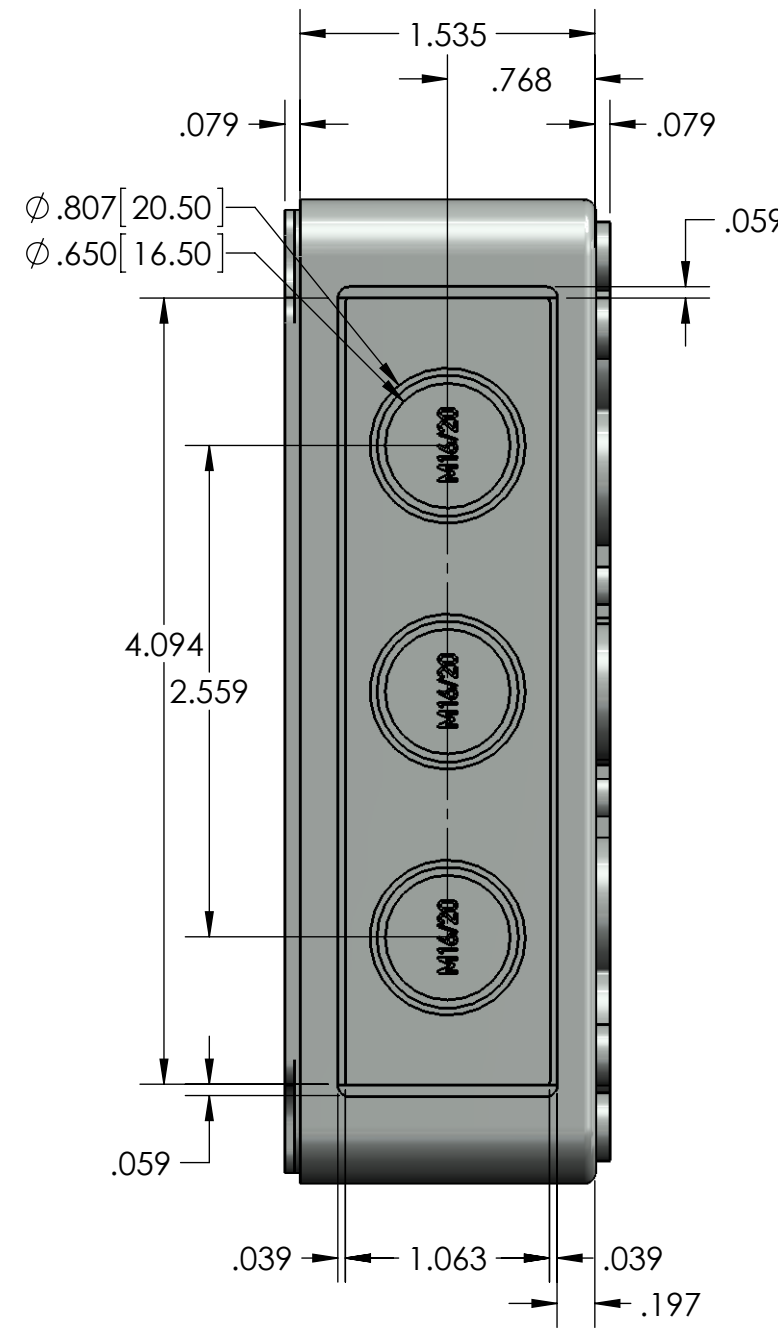
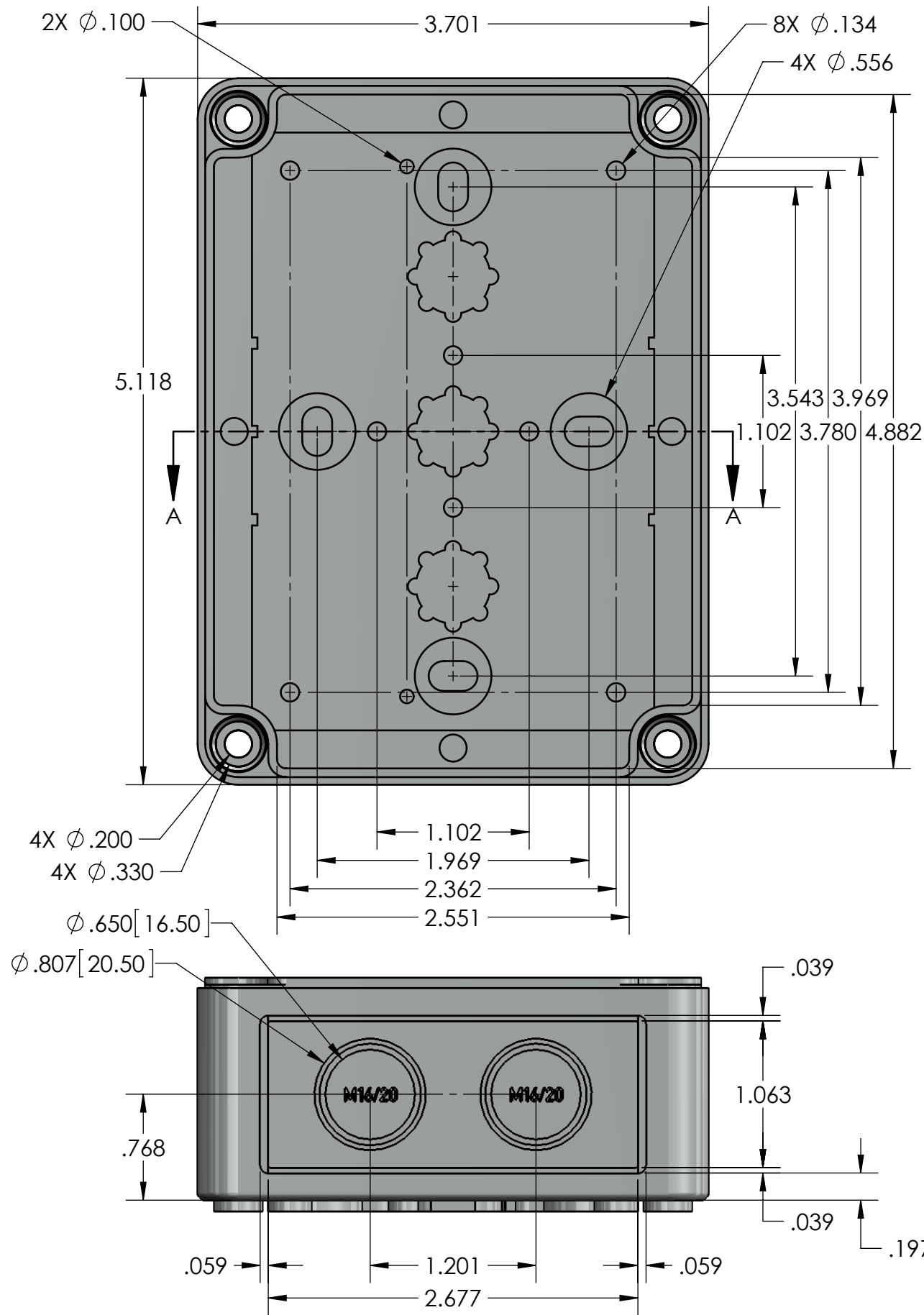
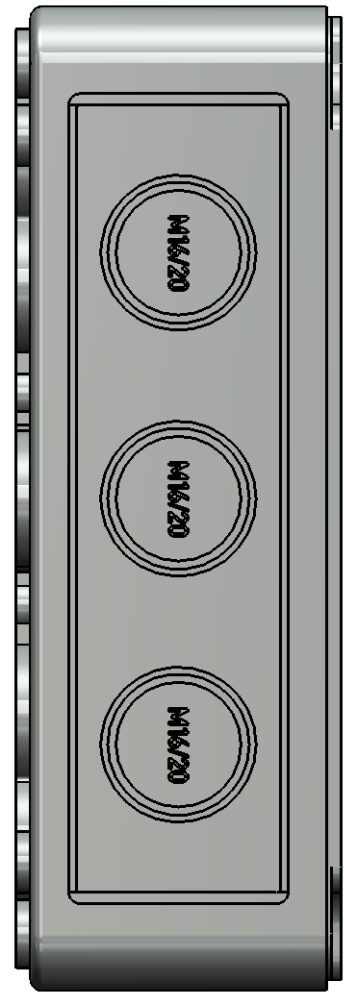

UNLESS OTHERWISE SPECIFIED: DIMENSIONS ARE IN: INCHES[mm] TOLERANCES: ANGULAR: ±2° TWO PLACE DECIMAL: ± THREE PLACE DECIMAL: ± PRINTED GRAPHICS: ±.010		PART NO. SK-15B-02		 <small>1305 CHESTER RD. PARKWAY AVON, OHIO 44011-1083 U.S.A. PH: 1-800-248-1233 440-934-0444 FAX: 440-934-0088</small>	
PROPRIETARY AND CONFIDENTIAL THE INFORMATION CONTAINED IN THIS DRAWING IS THE SOLE PROPERTY OF POLYCASE. ANY REPRODUCTION IN PART OR AS A WHOLE WITHOUT THE WRITTEN PERMISSION OF POLYCASE IS PROHIBITED. CAD FILE: SK-15B		MATERIAL GFR/PC			
REV.	DESCRIPTION	ZONE	BY	APPR'D	DATE
REVISIONS					
DRAWN CHECKED		NAME B.M.B.	DATE 8/18/2015 9/2/2015	SCALE: 1:1	
					BASE -
					REV -
					SHEET 1 OF 1