

BOM Table							
ITEM NO.	PART NUMBER	Rev.	Description	Material	Color	AN-12F-01/QTY.	AN-12F-02/QTY.
1	AN-12BF-01	-	ALUMINUM NEMA BASE	ALUMINUM ADC12	NATURAL	1	-
2	AN-12C-01	-	COVER	ALUMINUM ADC12	NATURAL	1	-
3	AN-12BF-02	-	ALUMINUM NEMA BASE	ALUMINUM ADC12	BLACK	-	1
4	AN-12C-02	-	COVER	ALUMINUM ADC12	BLACK	-	1
5	SCREWS-034-4	-	M4X0.7 X 20mm FHMS 4-PACK			1	1
6	GASKET-112-01	-	GASKET	SILICONE	GRAY	1	1

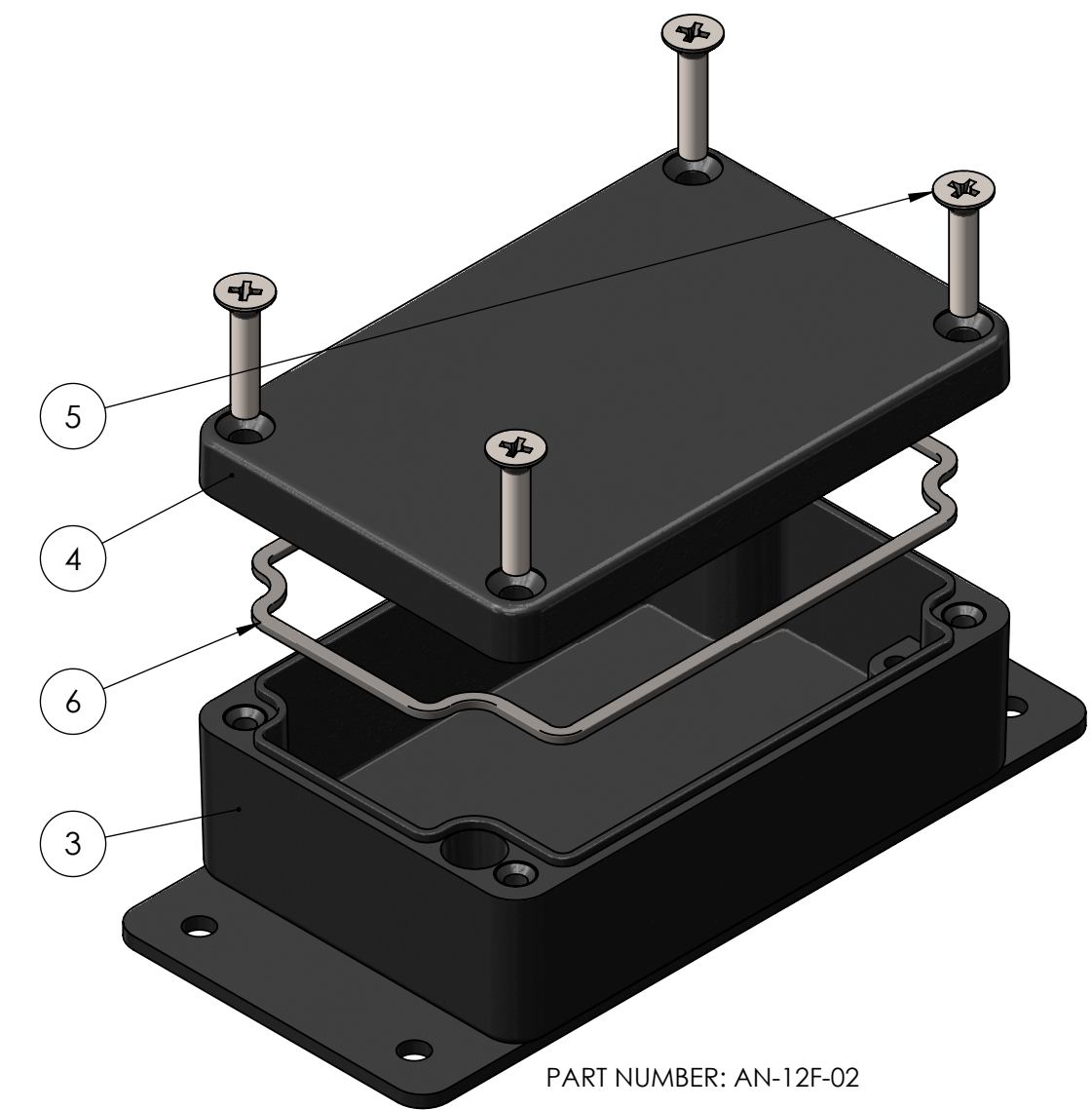
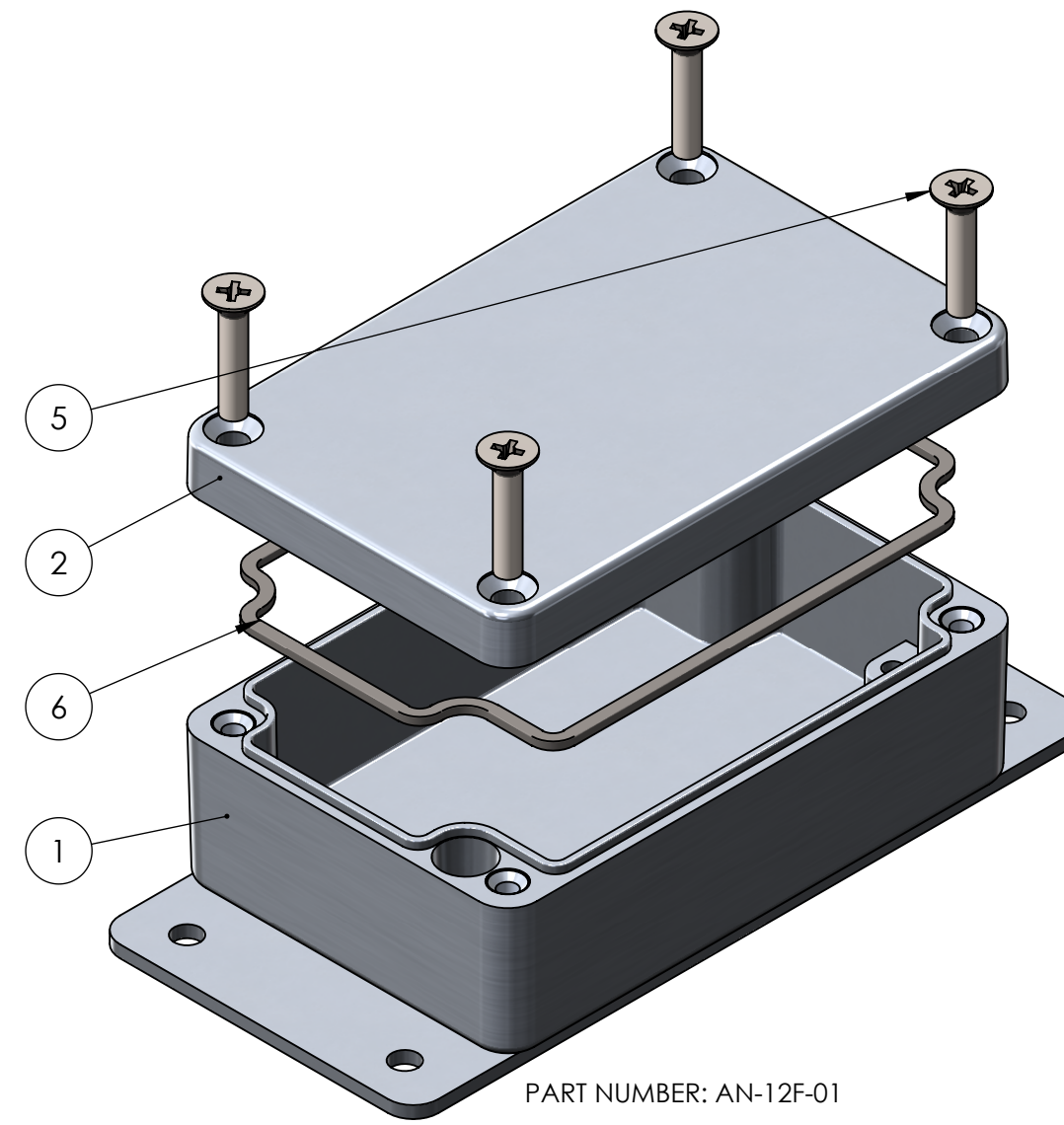
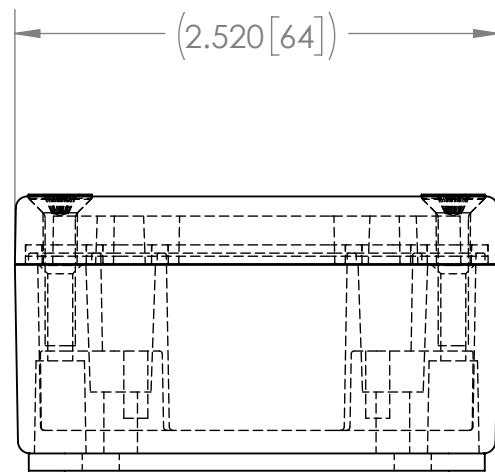
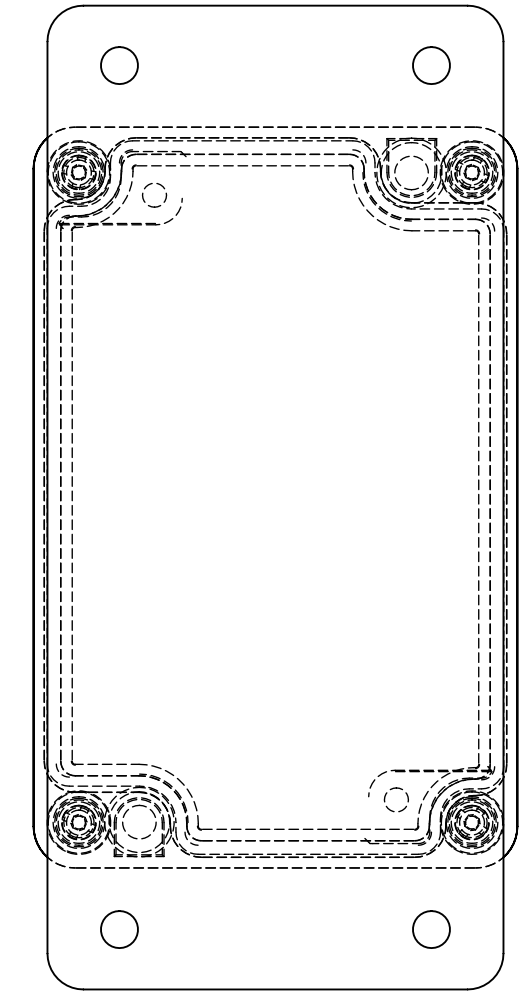
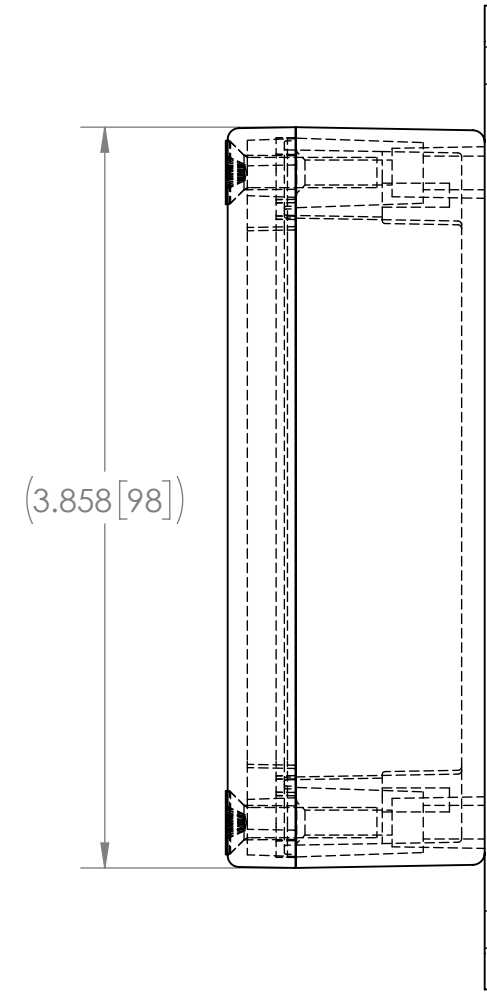
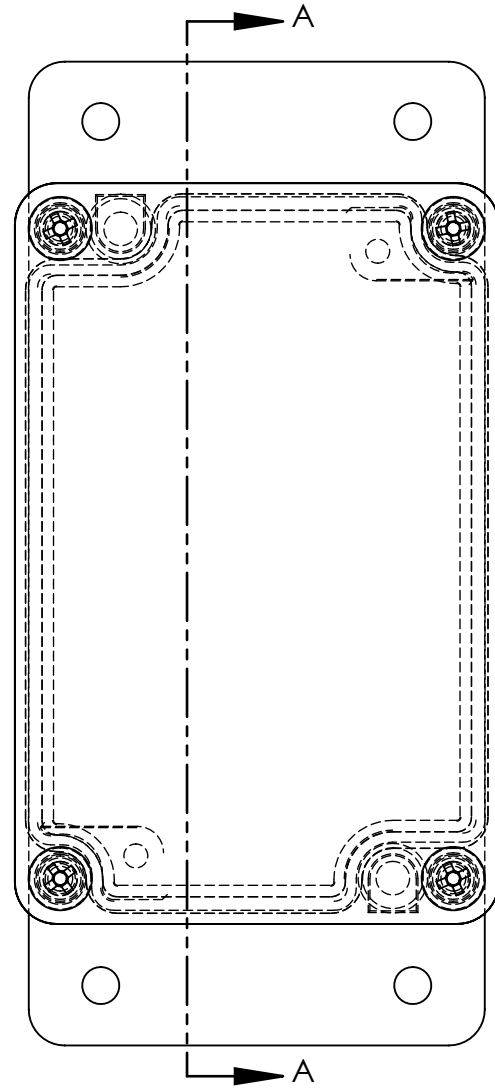
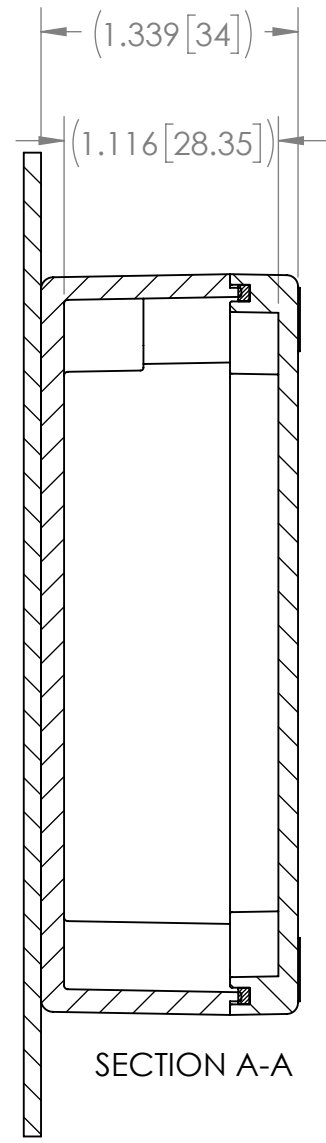

UNLESS OTHERWISE SPECIFIED:
 DIMENSIONS ARE IN: INCHES[mm]
 TOLERANCES: ANGULAR: ±2°
 TWO PLACE DECIMAL: ±.010
 THREE PLACE DECIMAL: ±.005
 PRINTED GRAPHICS: ±.010

PROPRIETARY AND CONFIDENTIAL
 THE INFORMATION CONTAINED IN THIS
 DRAWING IS THE SOLE PROPERTY OF
 POLYCASE. ANY REPRODUCTION IN PART
 OR AS A WHOLE WITHOUT THE WRITTEN
 PERMISSION OF POLYCASE IS PROHIBITED.
 CAD FILE: AN-12F

REV.	DESCRIPTION	ZONE	BY	APPR'D	DATE
	REVISIONS				

PART NO. AS NOTED
 MATERIAL AS NOTED
 FLAME RATING -
 SIZE C
 SCALE: 1:1

1305 CHESTER RD. PARKWAY AVON, OHIO 44011-1083 U.S.A.
 PH: 1-800-248-1233 440-934-0444 FAX: 440-934-0088

polycase
 REV -
 SHEET 1 OF 1

8 7 6 5 4 3 2 1

TOLERANCE CHART															
DIMENSION RANGE	0	.039	.118	.236	.394	.591	.866	1.181	1.575	2.087	2.756	3.543	4.724	6.299	7.874
	.039	.118	.236	.394	.591	.866	1.181	1.575	2.087	2.756	3.543	4.724	6.299	7.874	9.843
TOOL DEPENDENT	±.007	±.007	±.008	±.008	±.009	±.010	±.011	±.012	±.013	±.015	±.017	±.020	±.024	±.028	±.035
NON-TOOL DEPENDENT	±.003	±.004	±.004	±.004	±.005	±.006	±.007	±.008	±.009	±.011	±.013	±.016	±.020	±.024	±.031

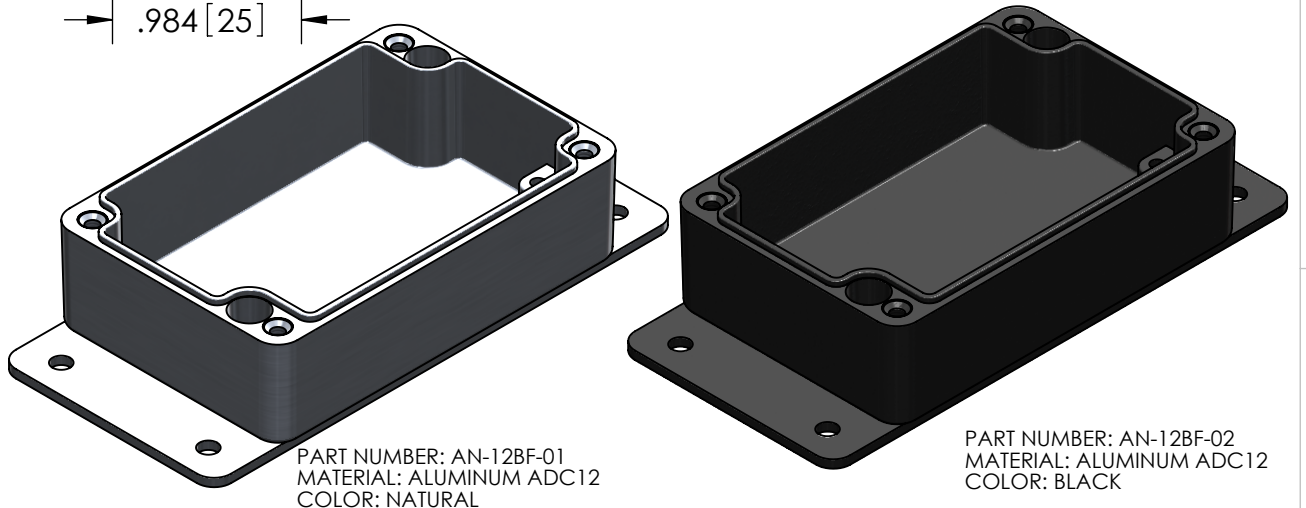
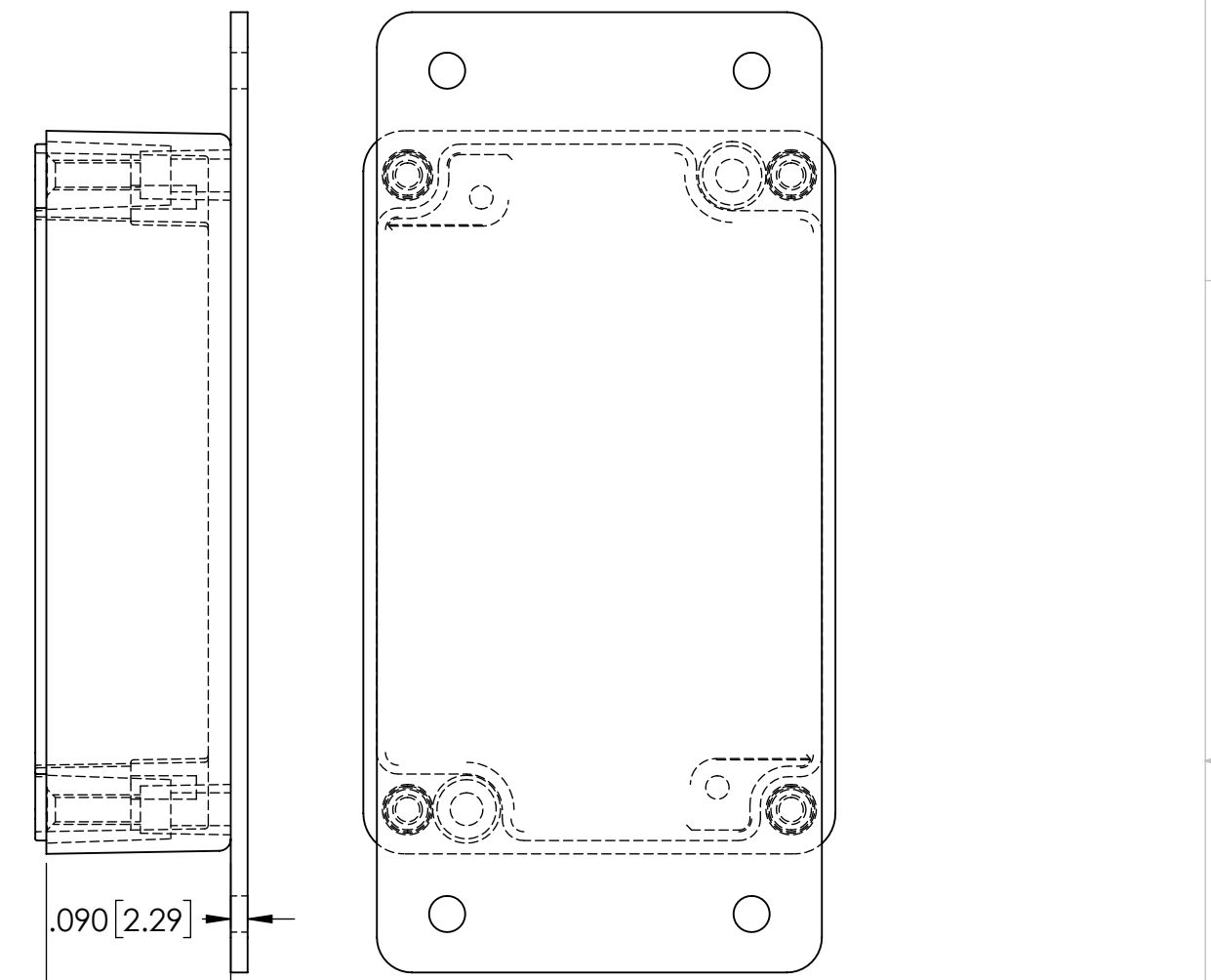
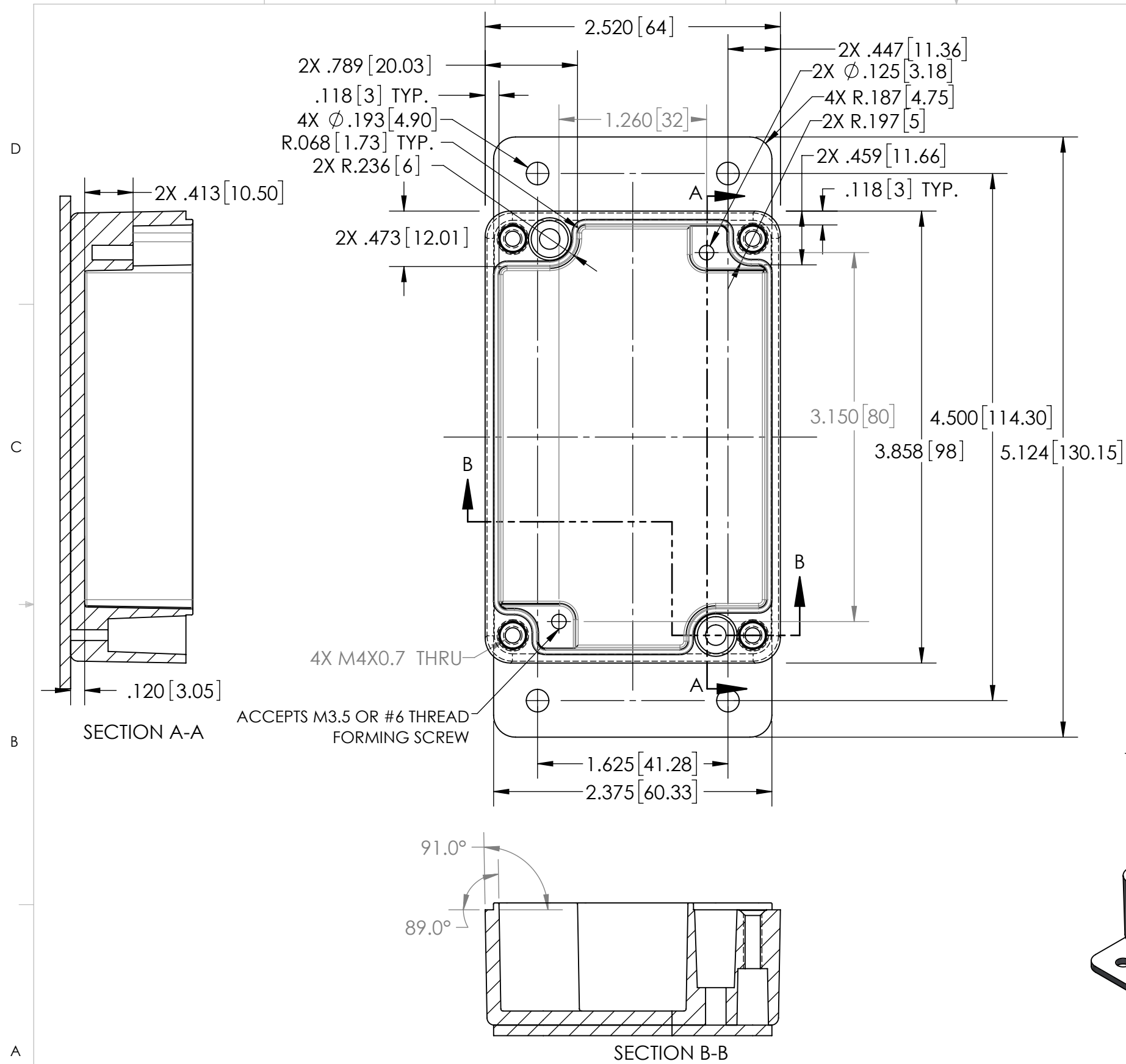

PART NUMBER: AN-12BF-01
 MATERIAL: ALUMINUM ADC12
 COLOR: NATURAL

PART NUMBER: AN-12BF-02
 MATERIAL: ALUMINUM ADC12
 COLOR: BLACK

UNLESS OTHERWISE SPECIFIED:
 DIMENSIONS ARE IN: INCHES [mm]
 TOLERANCES: ANGULAR: ±.5°
 TWO PLACE DECIMAL: ±
 THREE PLACE DECIMAL: ±
 PRINTED GRAPHICS: ±.010

PROPRIETARY AND CONFIDENTIAL
 THE INFORMATION CONTAINED IN THIS
 DRAWING IS THE SOLE PROPERTY OF
 POLYCASE. ANY REPRODUCTION IN PART
 OR AS A WHOLE WITHOUT THE WRITTEN
 PERMISSION OF POLYCASE IS PROHIBITED.
 CAD FILE: AN-12BF

PART NO. AS NOTED		MATERIAL AS NOTED	
FLAME RATING -		SIZE B	REV -
DRAWN C.C.B.	NAME D.M.F.	DATE 5/3/2018	SCALE: 1:1
CHECKED	C.C.B.	5/8/2018	

1305 CHESTER IND. PARKWAY AVON, OHIO 44011-1083 U.S.A.
 PH#: 1-800-248-1233, 440-934-0444 FAX#: 440-934-0088

REV.	DESCRIPTION	ZONE	BY	APPR'D	DATE
REVISIONS					

8 7 6 5 4 3 2 1

8 7 6 5 4 3 2 1

TOLERANCE CHART													
DIMENSION RANGE	0	.039	.118	.236	.394	.591	.866	1.181	1.575	2.087	2.756	3.543	4.724
	.039	.118	.236	.394	.591	.866	1.181	1.575	2.087	2.756	3.543	4.724	6.299
TOOL DEPENDENT	±.007	±.007	±.008	±.008	±.009	±.010	±.011	±.012	±.013	±.015	±.017	±.020	±.024
NON-TOOL DEPENDENT	±.003	±.004	±.004	±.004	±.005	±.006	±.007	±.008	±.009	±.011	±.013	±.016	±.020

D
C
B
A

D
C
B
A

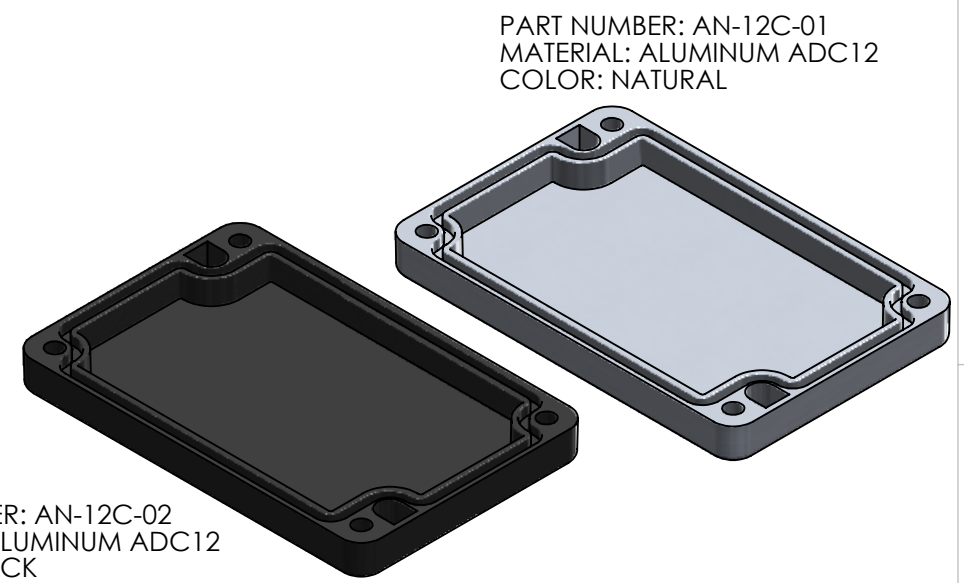
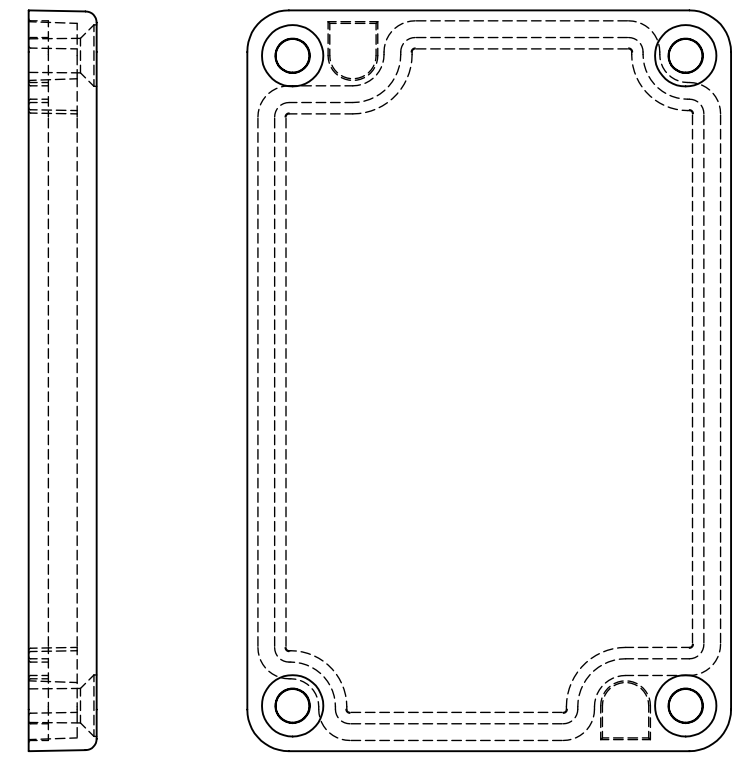
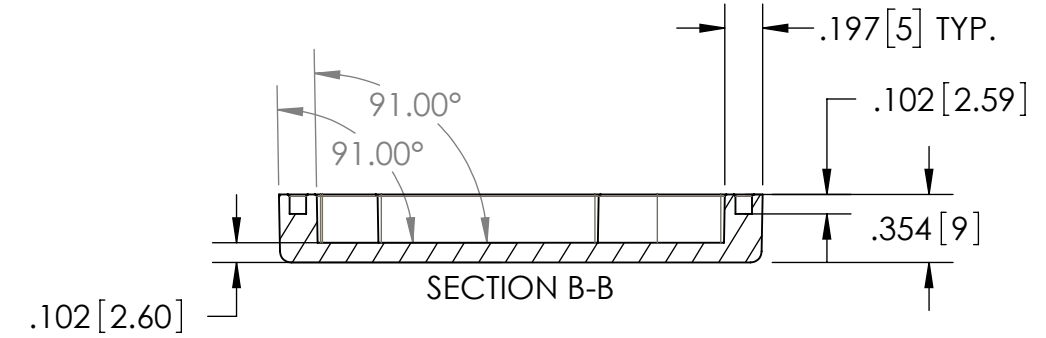
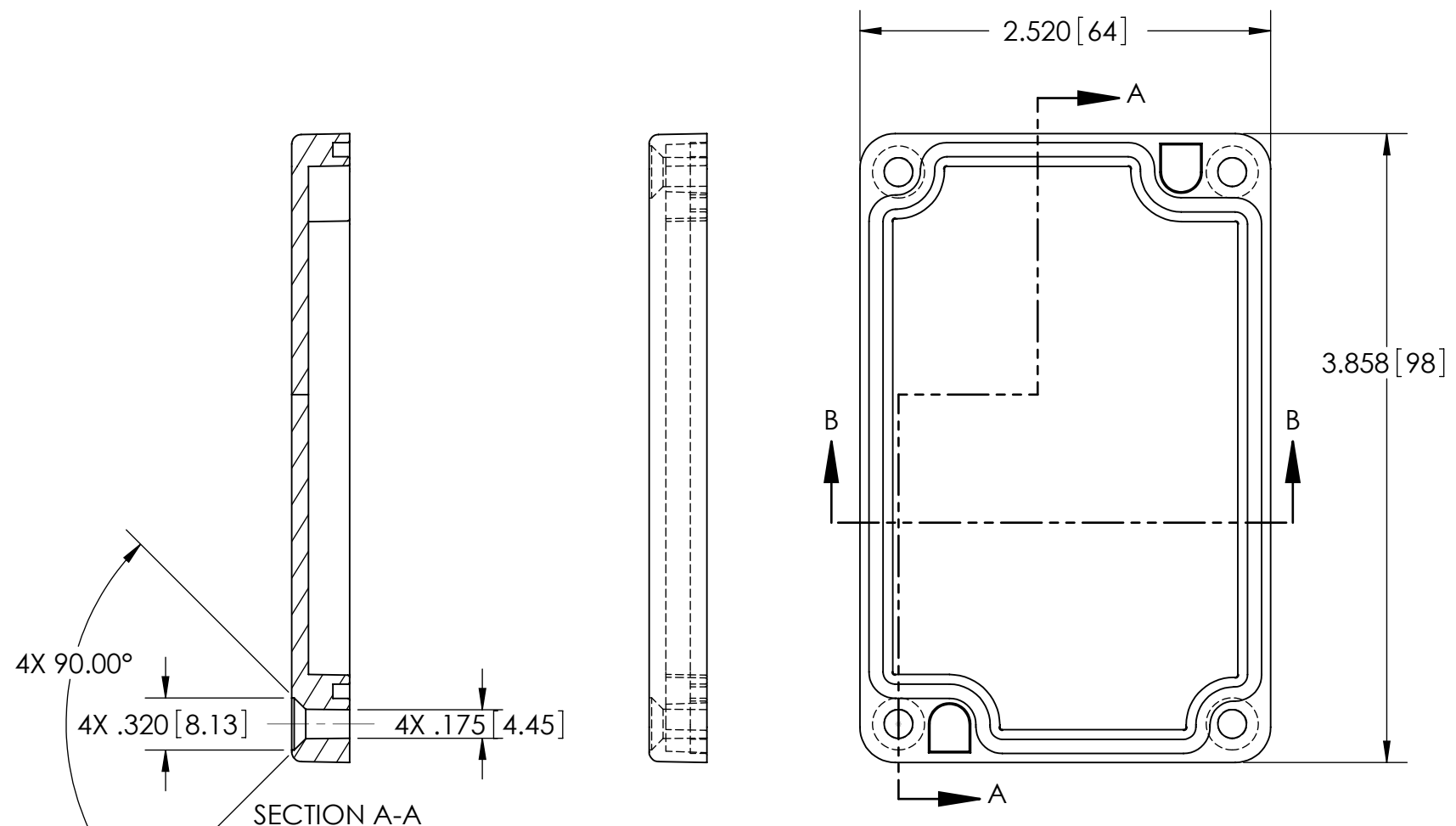

UNLESS OTHERWISE SPECIFIED: DIMENSIONS ARE IN: INCHES[mm] TOLERANCES: ANGULAR: ±.5° TWO PLACE DECIMAL: ± THREE PLACE DECIMAL: ± PRINTED GRAPHICS: ±.010	PART NO. AS NOTED		 <small>1305 CHESTER IND. PARKWAY AVON, OHIO 44011-1083 U.S.A. PH#: 1-800-248-1233, 440-934-0444 FAX#: 440-934-0088</small>	
	MATERIAL AS NOTED			
	FLAME RATING -	SIZE B	COVER	REV -
	PROPRIETARY AND CONFIDENTIAL THE INFORMATION CONTAINED IN THIS DRAWING IS THE SOLE PROPERTY OF POLYCASE. ANY REPRODUCTION IN PART OR AS A WHOLE WITHOUT THE WRITTEN PERMISSION OF POLYCASE IS PROHIBITED. CAD FILE: AN-12C	DRAWN D.M.F.	DATE 11/15/2016	SCALE: 1:1

REV.	DESCRIPTION	ZONE	BY	APPR'D	DATE
REVISIONS					

8 7 6 5 4 3 2 1